

TECHNICAL MANUAL

**ORGANIZATIONAL, DIRECT SUPPORT,
AND GENERAL SUPPORT MAINTENANCE
REPAIR PARTS AND SPECIAL TOOLS LISTS
(INCLUDING DEPOT MAINTENANCE REPAIR
PARTS AND SPECIAL TOOLS)**

FOR

**MAINTENANCE KIT
MK-1035/ARC-131
(NSN 5821-00-935-0058)**

TECHNICAL MANUAL }
 No. 11-6625-1610-24P }

HEADQUARTERS
 DEPARTMENT OF THE ARMY
 WASHINGTON, DC, 15 March 1977

ORGANIZATIONAL, DIRECT SUPPORT, AND GENERAL SUPPORT MAINTENANCE
 REPAIR PARTS AND SPECIAL TOOLS LISTS

(INCLUDING DEPOT MAINTENANCE REPAIR PARTS AND SPECIAL TOOLS)

FOR

MAINTENANCE KIT MK-1035/ARC-131

(NSN 5821-00-935-0058)

Current as of 28 November 1976

REPORTING OF ERRORS

You can improve this manual by recommending improvements using DA Form 2028-2 (Test) located in the back of the manual. Simply tear out the self-addressed form, fill it out as shown on the sample, fold it where shown, and drop it in the mail.

If there are no blank DA Forms 2028-2 (Test) in the back of your manual, use the standard DA Form 2028 (Recommended Changes to Publications and Blank Forms) and forward to the Commander, US Army Electronics Command, ATTN: DRSEL-MA-Q, Fort Monmouth, New Jersey 07703.

In either case a reply will be furnished direct to you.

Table of Contents

		Page	Illus Figure
Section	I. Introduction	1	
	II. Repair parts list	5	
Group	00 Maintenance Kit, Electronic Equipment MK-1035/ARC-131	5	1
	01 Cable Assembly, Special Purpose CX-10569/ARC-131	7	2
	02 Cable Assembly, Radio Frequency CG-3370/U (W8)	8	3
	03 Cable Assembly, Radio Frequency CG-3370/U (W6)	9	4
	04 Cable Assembly, Special Purpose CX-10570/U (W1)	10	5
	05 Cable Assembly, Special Purpose CX-10572/U (W3)	11	6
	06 Cable Assembly, Special Purpose CX-10573/U (W4)	12	7
	07 Cable Assembly, Radio Frequency CG-3374/U (W11)	13	8
	08 Cable Assembly, Radio Frequency CG-3375/U (W12)	14	9
	09 Cable Assembly, Power Electrical CX-10575/U (W16)	15	10
	10 Cable Assembly, Radio Frequency CG-3371/U (W7)	16	11
	11 Cable Assembly, Radio Frequency CG-3376/U (W15)	17	12
	12 Cable Assembly, Special Purpose CX-10574/ARC-131	18	13
	13 Cable Assembly, Radio Frequency CG-3372/U (W17)	19	14
	14 Cable Assembly, Radio Frequency CG-3373/U (W9)	20	15
	15 Cord Assembly, Electrical CX-10576/U (W8)	21	16
	16 Cable Assembly, Special Purpose CX-10571/U (W2)	22	17
	17 Case, test set	23	18

*This manual supersedes TM 11-6625-1610-20P-2 November 1979, and TM 11-6625-1610-34P-11 December 1973.

TM 11-6625-1610-24P

	Page	Illus Figure
18 Variable Attenuator TG-950	25	19
19 Simulator, Antenna SM-499/ARC-131	27	20
20 Test Set, Radio TS-2575/ARC-131	29	21-25
2001 Power supply	43	26
2002 Audio amplifier	45	27
2003 Control, Radio Set C-7088/ARC-131 (See TM 11-5820-670-20P and TM 11-5820-670-34P for parts)		
2004 Control, Intercommunication Set C-1611(*)/A1C (See TM 11-5831-201-20P and TM 11- 5831-201-35P for parts)		
2005 Indicator ID-48/ARN (No parts authorized)		
Section III. Special tools List (Not applicable)		
IV National stock number and part number index	46	

SECTION I

INTRODUCTION

1. Scope

This manual lists spares and repair parts; special tools; special test, measurement, and diagnostic equipment (TMDE), and other special support equipment required for performance of organizational, direct support and general support maintenance of the MK-1035/ARC-131.

It authorizes the requisitioning and issue of spares and repair parts as indicated by the source and maintenance codes.

2. General

This Repair Parts and Special Tools List is divided into the following sections:

a. *Section II. Repair Parts List.* A list of spares and repair parts authorized for use in the performance of maintenance. The list also includes parts which must be removed for replacement of the authorized parts. Parts lists are composed of functional groups in numeric sequence, with the parts in each group listed in figure and item number sequence.

b. *Section III. Special Tools List.* Not applicable.

c. *Section IV. National Stock Number and Part Number Index.* A list, in National item identification number (NIIN) sequence, of all National stock numbers (NSN) appearing in the listings, followed by a list, in alphanumeric sequence, of all part numbers appearing in the listings. National stock numbers and part numbers are cross-referenced to each illustration figure and item number appearance.

3. Explanation of columns

a. *Illustration.* This column is divided as follows:

(1) *Figure number.* Indicates the figure number of the illustration on which the item is shown.

(2) *Item number.* The number used to identify item called out in the illustration.

b. *Source, Maintenance, and Recoverability (SMR) Codes.*

(1) *Source code.* Source codes indicate the manner of acquiring support items for maintenance, repair, or overhaul of end items. Source codes are entered in the first and second positions of the Uniform SMR Code format as follows:

Code

Definition

PA-Item procured and stocked for anticipated or known usage.

XD-A support item that is not stocked. When required, item will be procured through normal supply channels.

NOTE

Cannibalization or salvage may be used as a source of supply for any items source coded above except those coded XA and aircraft support items as restricted by AR 700-42.

(2) *Maintenance code.* Maintenance codes are assigned to indicate the levels of maintenance authorized to USE and REPAIR support items. The maintenance codes are entered in the third and fourth positions of the Uniform SMR Code format as follows:

(a) The maintenance code entered in the third position will indicate the lowest maintenance level authorized to remove, replace, and use the support item. The maintenance code entered in the third position will indicate one of the following levels of maintenance:

Code

Application/Explanation

O- Support item is removed, replaced, used at the organizational level.

F- Support item is removed, replaced, used at the direct support level.

D - Support items that are removed, replaced, used at depot, mobile depot, specialized repair activity only.

(b) The maintenance code entered in the fourth position indicates whether the item is to be repaired and identifies the lowest maintenance level with the capability to perform complete repair (i.e., all authorized maintenance functions). This position will contain one of the following maintenance codes:

Code

Application/Explanation

F- the lowest maintenance level capable of complete repair of the support item is the direct support level.

D- The lowest maintenance level capable of complete repair of the support item is the depot level.

Z - Non repairable. No repair is authorized.

(3) *Recoverability code.* Recoverability codes are assigned to support items to indicate the disposition action on unserviceable items. The recoverability code is entered in the fifth position of the Uniform SMR Code format as follows:

Recoverability codes

Definition

Z-Nonreparable item. When unserviceable, condemn and dispose at the level indicated in position 3.

F-Repairable item. When uneconomically repairable, condemn and dispose at the direct support level,

D-Repairable item, When beyond lower level repair capability. return to depot. Condemnation and disposal not authorized below depot level.

c. *National Stock Number.* Indicates the National stock number assigned to the item and will be used for requisitioning purposes.

d. *Part Number* Indicates the primary number used by the manufacturer (individual, company, firm, corporation, or Government, activity), which controls the design and characteristics of the item by means of its engineering drawings, specifications, standards, and inspection requirement, to identify an item or range of items.

NOTE

When a stock numbered item is requisitioned, the repair part received may have a different part number than the part being replaced.

c. *Federal supply Code for Manufacturer (FSCM).* The FSCM is a 5-digit numeric code listed in SB 708-42 which is used to identify the manufacturer, distributor, or Government agency, etc.

f. *Description,* Indicates the Federal item name and, if required, a minimum description to identify the item.

g. *Unit of Measure (U/M).* Indicates the standard of the basic quantity of the listed item as used in performing the actual maintenance function. This measure is expressed by a two-character alphabetical abbreviation (e.g., ea, in, pr, etc). When the unit of measure differs from the unit of issue, the lowest unit of issue that will satisfy the required units of measure will be requisitioned.

h. *Quantity Incorporated in Unit.* Indicates the quantity of the item used in the breakout shown on the illustration figure, which is prepared for a functional group, sub functional group, or an assembly.

4. Special Information

The following publications pertain to the MK-1035/ARC-131 and its components:

TM 11-5820-670-12, Radio Set AN/ARC-131

TM 11-5820-670-20P, Radio Set AN/ARC-131

TM 11-5820-670-34P, Radio Set AN/ARC-131

TM 11-5820-670-35, Radio Set AN/ARC-131

TM 11-5831-201-20, Control, Intercommunication Set, C-1611D/AIC and Discriminator, Discrete Signal MD-736/A

TM 11-5831-201-20P, Control, Intercommunication Set C-1611D/AC and Discriminator, Discrete Signal MD-736/A

TM 11-5831-201-35, Control, Intercommunication Set C-1611D/AIC and Discriminator, Discrete Signal MD-736/A

TM 11-5831-201-34P, Control, Intercommunication Set C-1611D/AIC and Discriminator, Discrete Signal MD-736/A

TM 11-6625-1610-12, Maintenance Kit MK-1035/ARC-131

TM 11-6625-1610-35, Maintenance Kit MK-1035/ARC-131

5. How to Locate Repair Parts

a. When National stock number or part number is unknown.

(1) *First.* Using the table of contents, determine the functional group within which the item belongs. This is necessary since illustrations are prepared for functional groups and listings are divided into the same groups.

(2) *Second.* Find the illustration covering the functional group to which the item belongs.

(3) *Third.* Identify the item on the illustration and note the illustration figure and Item number of the item.

(4) *Fourth,* Using the Repair Parts Listing, find the figure and item number noted on the illustration.

b. When National stock number or part number is known.

(1) *First.* Using the Index of National Stock Numbers and Part Numbers, find the pertinent National Stock number or part number. This index is in NIIN sequence followed by a list of part numbers in alphabetic sequence, cross-referenced to the illustration figure number and item number.

(2) *Second.* After finding the figure and item number, locate the figure and item number in the repair parts list.

6. Abbreviations

Not applicable.

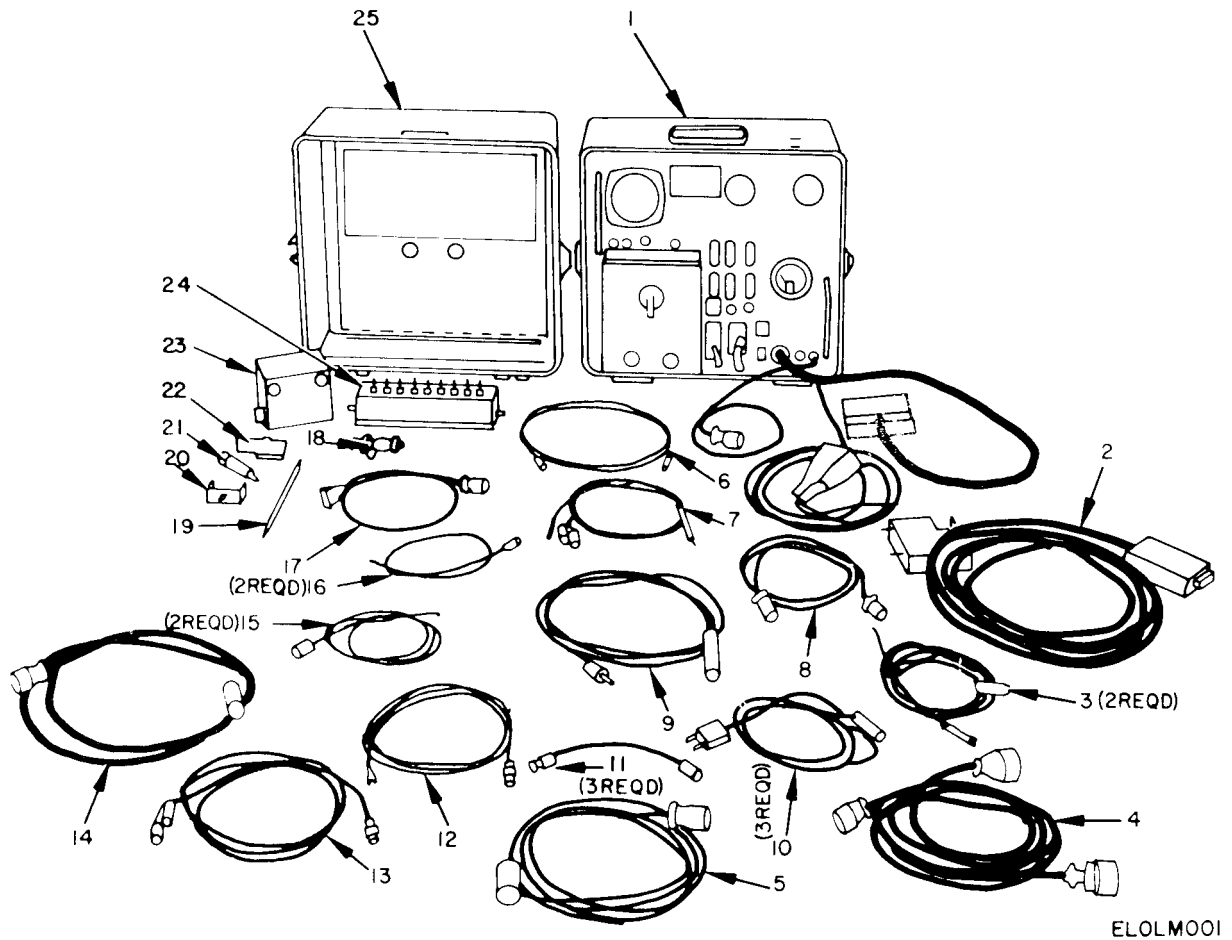
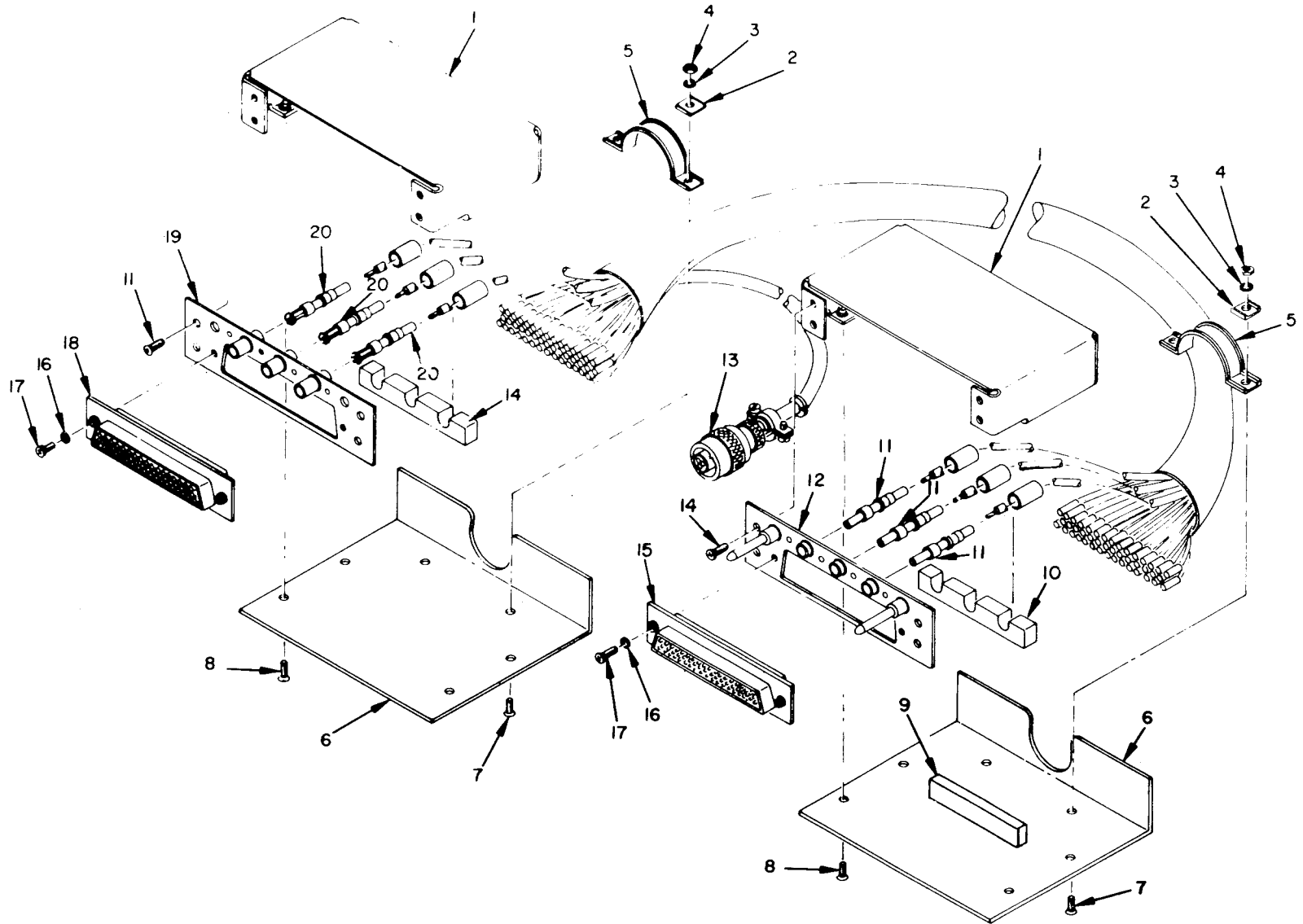

Figure 1. Maintenance Kit, Electronic Equipment MK-1035/ARC-131.

SECTION II (1) ILLUSTRATION (A) (B) FIG ITEM NO NO		(2) SMR CODE	(3) NATIONAL STOCK NUMBER	(4) PART NUMBER	(5) FSCM	TM11-6625-1610-24P (6) DESCRIPTION	(7) USABLE ON CODE U/M	(8) QTY INC IN UNIT
						GROUP 00 MAINTENANCE KIT,ELECTRONIC EQUIPMENT		
						MK-1035/ARC-131		
1	1	XDOFF		TS2575ARC131	80058	TEST SET,RADIO	EA	1
1	2	PAOFF	5995-00-241-6239	CX10569ARC131	80058	CABLE ASSEMBLY,SPECIAL PURPOSE,ELECTRICAL	EA	1
1	3	PAOFF	5995-00-935-0362	CG3373U6FT	80058	CABLE ASSEMBLY,RADIO FREQUENCY	EA	2
1	4	PAOFF	5995-00-832-6856	CX10574ARC131	80058	CABLE ASSEMBLY,SPECIAL PURPOSE,ELECTRICAL	EA	1
1	5	PAOFF	5995-00-935-0367	CX10573U6FT	80058	CABLE ASSEMBLY,SPECIAL PURPOSE	EA	1
1	6	PAOFF	5995-00-935-0366	CG3370U81N	80058	CABLE ASSEMBLY,RADIO FREQUENCY	EA	1
1	7	PAOFF	5995-00-933-0370	CX10575U6FT	80058	CABLE ASSEMBLY,POWER ELECTRICAL	EA	1
1	8	PAOFF	5995-00-935-0374	CX10570U4FT	80058	CABLE ASSEMBLY,SPECIAL PURPOSE,ELECTRICAL	EA	1
1	9	PAOFF	5995-00-832-7124	CX10576U6FT	80058	CORD ASSEMBLY,ELECTRICAL	EA	1
1	10	PAOFF	5995-00-935-0363	CG3371U6FT	80058	CABLE ASSEMBLY,RADIO FREQUENCY	EA	3
1	11	PAOFF	5995-00-935-0358	CG3370U6FT	80058	CABLE ASSEMBLY,RADIO FREQUENCY	EA	3
1	12	PAOFF	5995-00-935-0364	CG3372U6FT	80058	CABLE ASSEMBLY,RADIO FREQUENCY	EA	1
1	13	PAOFF	5995-00-935-0371	CG3376U6FT	80058	CABLE ASSEMBLY,RADIO FREQUENCY	EA	1
1	14	PAOFF	5995-00-935-0365	CX10572U6FT	80058	CABLE ASSEMBLY,SPECIAL PURPOSE,ELECTRICAL	EA	1
1	15	PAOFF	6625-00-935-0332	CG3375U4FT	80058	CABLE ASSEMBLY,RADIO FREQUENCY	EA	2
1	16	PAOFF	5995-00-935-0361	CG3374U2FT	80058	CABLE ASSEMBLY,RADIO FREQUENCY	EA	2
1	17	PAOFF	5995-00-935-0375	CX10571U4FT	80058	CABLE ASSEMBLY,SPECIAL PURPOSE,ELECTRICAL	EA	1
1	18	XDOZZ		TL758ARC131	80058	ALIGNMENT TOOL,COUPLER ASSEMBLY	EA	1
1	19	PAOZZ	5120-00-724-3767	SMC620627	80063	ALIGNMENT TOOL,ELECTRICAL EQUIPMENT	EA	1
1	20	PAOZZ	5935-00-089-8060	SMC620747	80063	ADAPTER,CONNECTOR TO PLUG	EA	1
1	21	PAOZZ	5120-00-065-2761	TL711AARM79	80058	EXTRACTOR,CONTACT ELECTRICAL ASSEMBLY	EA	1
1	22	PAOZZ	4920-00-976-5426	SMC620628	80063	DIVIDER,POWER,RADIO FREQUENCY	EA	1
1	23	PAOOO	6625-00-832-6023	SM499ARC131	80063	SIMULATOR,COUPLER,ANTENNA-ASSEMBLY	EA	1
1	24	PAOOO	5985-00-075-3482	SMC620629	80063	ATTENUATOR,VARIABLE	EA	1
1	25	XDFFF		SMD620682	80063	CASE,TEST SET	EA	1



ELOLM002

Figure 2. Cable Assembly, Special Purpose CX-10569/ARC-131.

SECTION II (1) ILLUSTRATION (A) (B) FIG ITEM NO NO		(2) SMR CODE	(3) NATIONAL STOCK NUMBER	(4) PART NUMBER	(5) FSCM	TM11-6625-1610-24P (6) DESCRIPTION	(7) USABLE ON CODE U/M	(8) QTY INC IN UNIT
						GROUP 01 CABLE ASSEMBLY SPECIAL PURPOSE		
						CX-10569/ARC-131		
2	1	XDFZZ		SMC620674	80063	COVER, ELECTRICAL CONNECTOR	EA	2
2	2	PAFZZ	5310-00-672-2178	D4-128	95987	WASHER, LOOP CLAMP	EA	4
2	3	XDFZZ		NAS1640-4	80205	WASHER, LOCK	EA	4
2	4	PAFZZ	5310-00-208-3786	NAS671C4	80205	NUT, PLAIN, HEXAGON	EA	4
2	5	PAFZZ	5340-00-071-6537	NAS1397R8B	80205	CLAMP, LOOP	EA	2
2	6	XDFZZ		SMC620672	80063	SHELL, ELECTRICAL CONNECTOR	EA	2
2	7	PAFZZ	5305-00-066-7325	MS24693C5	96906	SCREW, MACHINE	EA	4
2	8	PAFZZ	5305-00-056-9961	MS24693C4	96906	SCREW, MACHINE	EA	8
2	9	XDFZZ	5970-00-138-8798	SMB620752	80063	SPACER, ELECTRICAL CONNECTOR	EA	1
2	10	XDFZZ	5970-00-138-8800	SMB620735	80063	SPACER	EA	2
2	11	PAFZZ	5935-00-910-5098	DM53740-5005	71468	CONTACT, ELECTRICAL SNAP-IN	EA	3
2	12	XDFZZ		SMC620699	80063	PLATE, MOUNTING, CONNECTOR	EA	1
2	13	PAFZZ	5935-00-892-9322	MS3116F8-4S	96906	CONNECTOR, PLUG, ELECTRICAL	EA	1
2	14	PAFZZ	5305-00-054-5648	MS51957-14	96906	SCREW, MACHINE	EA	8
2	15	PAFZZ	5935-00-493-0466	MS4308-3-5	96906	CONNECTOR, RECEPTACLE, ELECTRICAL	EA	1
2	16	PAFZZ	5310-00-928-2690	NAS1640-2	80205	WASHER, LOCK	EA	4
2	17	PAFZZ	5305-00-054-5637	MS51957-3	96906	SCREW, MACHINE	EA	1
2	18	PAFZZ	5935-00-904-1373	DDMF-50S	71468	CONNECTOR, RECEPTACLE, ELECTRICAL	EA	1
2	19	PAFZZ	5935-00-897-2074	DD50925-1	71468	PLATE, MOUNTING, CONNECTOR	EA	1
2	20	PAFZZ	5999-00-728-3617	DM53742-5004	71468	CONTACT, ELECTRICAL SNAP-IN	EA	3

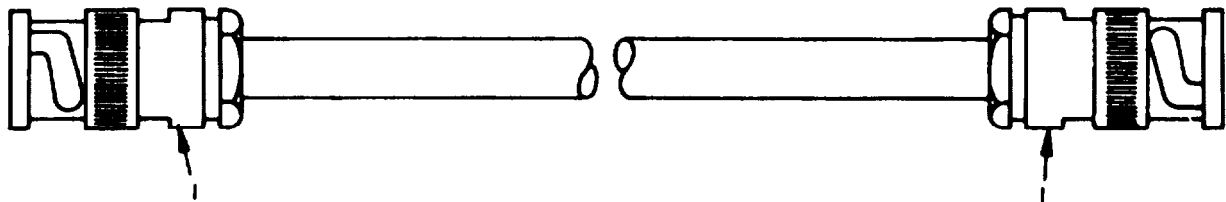

ELOLM003

Figure 3. Cable Assembly, Radio Frequency CG-3370/U (W8),

(1) ILLUSTRATION		(2)	(3)	(4)	(5)	(6)	(7)	(8)
(a) FIG NO	(b) ITEM NO	SMR CODE	NATIONAL STOCK NUMBER	PART NUMBER	FSCM	DESCRIPTION USABLE ON CODE	U/M	QTY INC IN UNIT
3	1	PAFZZ	5935-00-823-0487	MS35168-88E	96906	GROUP 02 CABLE ASSEMBLY, RADIO FREQUENCY 00-3370/U (W8) CONNECTOR, PLUG, ELECTRICAL	EA	2

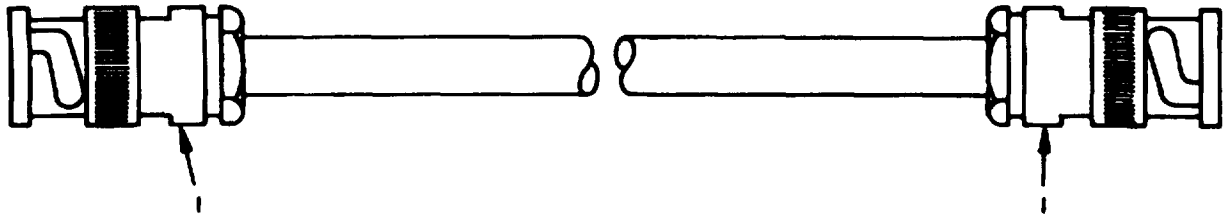

ELOLM004

Figure 4. Cable Assembly, Radio Frequency CG-3370/U (W6),

(1) ILLUSTRATION		(2)	(3)	(4)	(3)	(6)	(7)	(8)
(a) FIG NO	(b) ITEM NO	SMR CODE	NATIONAL STOCK NUMBER	PART NUMBER	FSCM	DESCRIPTION USABLE ON CODE	U/M	QTY INC IN UNIT
4	1	PAFZZ	5935-00-823-0487	MS35168-88E	96906	GROUP 03 CABLE ASSEMBLY, RADIO FREQUENCY CG-3370/U (W6) CONNECTOR, PLUG, ELECTRICAL	EA	2

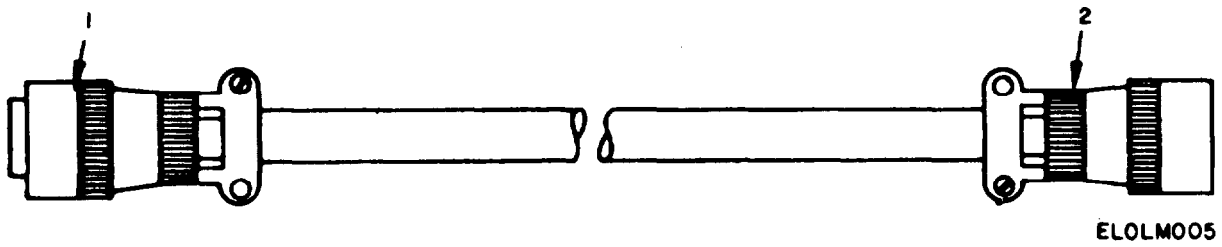
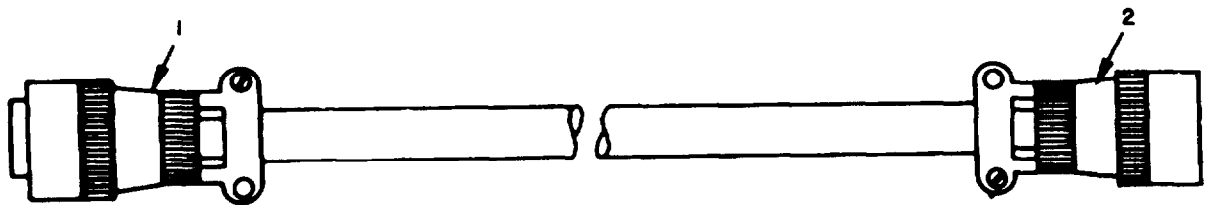

Figure 5. Cable Assembly, Special Purpose CX-10570/U (W1).

(1) ILLUSTRATION		(2)	(3)	(4)	(5)	(6)	(7)	(8)
(a) FIG NO	(b) ITEM NO	SMR CODE	NATIONAL STOCK NUMBER	PART NUMBER	FSCM	DESCRIPTION USABLE ON CODE	U/M	QTY INC IN UNIT
						GROUP 04 CABLE ASSEMBLY, SPECIAL PURPOSE CX-10570/U (W1)		
5	1	PAFZZ	5935-00-771-2262	MS3116F12-10P	96906	CONNECTOR, PLUG, ELECTRICAL	EA	1
5	2	PAFZZ	5935-00-761-3881	MS3116F8-4P	96906	CONNECTOR, PLUG, ELECTRICAL	EA	1



ELOLM006

Figure 6. Cable Assembly, Special Purpose CX-10572/U (W3).

(1) ILLUSTRATION		(2)	(3)	(4)	(5)	(6)	(7)	(8)
(a) FIG NO.	(b) ITEM NO.	SMR CODE	NATIONAL STOCK NUMBER	PART NUMBER	FSCM	DESCRIPTION USABLE ON CODE	U/M	QTY INC IN UNIT
						GROUP 05 CABLE ASSEMBLY, SPECIAL PURPOSE CX-10572/U (W3)		
6	1	PAFZZ	5935-00-771-2262	MS3116F12-10P	96906	CONNECTOR, PLUG, ELECTRICAL	EA	1
6	1	PAFZZ	5935-00-892-9322	MS3116F8-4S	96906	CONNECTOR, PLUG, ELECTRICAL	EA	1

6625-1610-24P

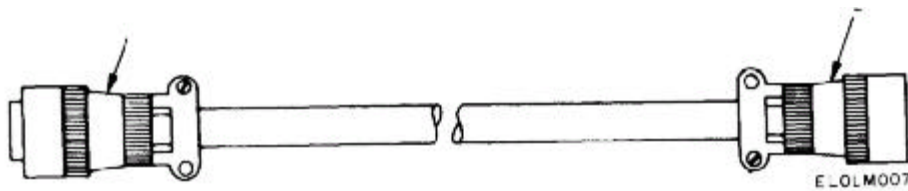
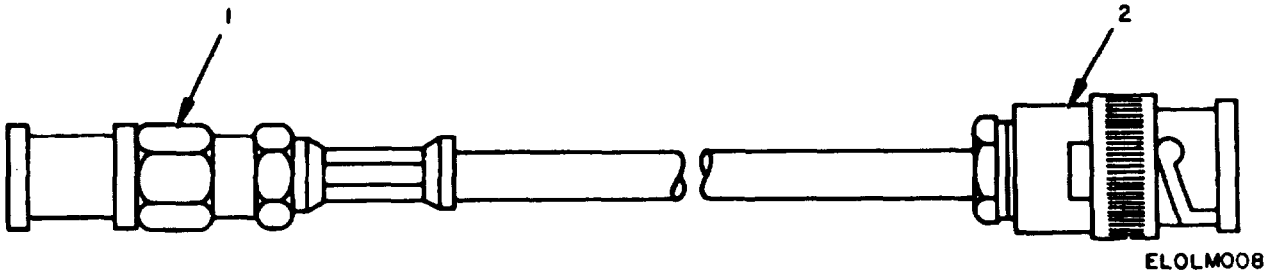

Figure 7. Cable Assembly, Special Purpose CX-10573/U (W4).

FIG NO	ITEM NO	SMR CODE	NATIONAL STOCK NO	PART NO	DESCRIPTION	UM	QTY
7	1	PAFZZ	5935-00-771-2262	MS3116F12-10P	(fscm) 960609 Connector, Plug Elec	ea	1
7	2	PAFZZ	5935-00-762-1495	MS3116F12-10S	(fscm) 9696 Connector, Plug, Elec	ea	1



ELOLMO08

Figure 8. Cable Assembly, Radio Frequency CG-3374/U (W11).

(1) ILLUSTRATION		(2)	(3)	(4)	(5)	(6)	(7)	(8)
(a) FIG NO	(b) ITEM NO	SMR CODE	NATIONAL STOCK NUMBER	PART NUMBER	FSCM	DESCRIPTION USABLE ON CODE	U/M	QTY INC IN UNIT
						GROUP 07 CABLE ASSEMBLY, RADIO FREQUENCY CO-3374/U (W11)		
8	1	PAFZZ	5935-00-053-4793	819B1800W	94375	CONNECTOR, PLUG, ELECTRICAL	EA	1
8	2	PAFZZ	9535-00-067-6290	51-025-0000	96291	CONNECTOR, PLUG, ELECTRICAL	EA	1

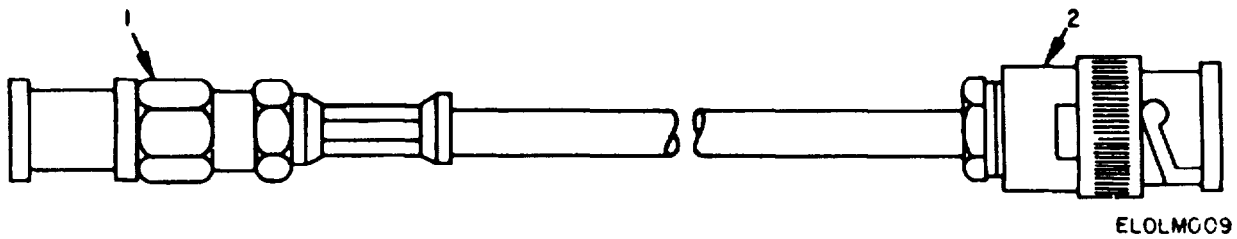
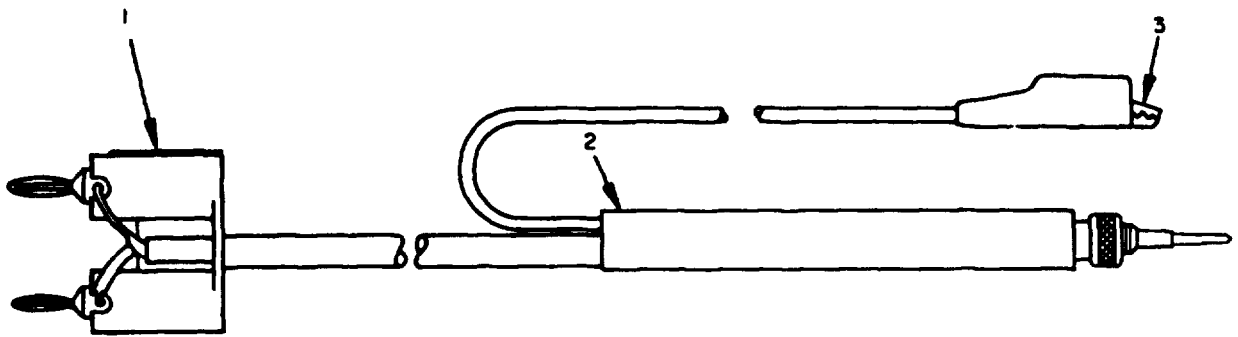

Figure 9. Cable Assembly, Radio Frequency CG-3375/U (W12).

(1) ILLUSTRATION		(2)	(3)	(4)	(5)	(6)	(7)	(8)
(a) FIG NO	(b) ITEM NO	SMR CODE	NATIONAL STOCK NUMBER	PART NUMBER	FSCM	DESCRIPTION	USABLE ON CODE	QTY INC IN UNIT
9	1	PAFZZ	5935-00-053-4793	819B1800W	94375	GROUP 08 CABLE ASSEMBLY, RADIO FREQUENCY CG-3375/U (W12)		EA 1
9	2	PAFZZ	5935-00-945-7354	51-024-0000	98291	CONNECTOR, PLUG, ELECTRICAL		EA 1



ELOLMOIO

Figure 10. Cable Assembly, Power Electrical CX-10575/U (W16).

(1) ILLUSTRATION		(2)	(3)	(4)	(5)	(6)	(7)	(8)
(a) FIG NO	(b) ITEM NO	SMR CODE	NATIONAL STOCK NUMBER	PART NUMBER	FSCM	DESCRIPTION USABLE ON CODE	U/M	QTY INC IN UNIT
						GROUP 09 CABLE ASSEMBLY, POWER ELECTRICAL CX-10575/U (W16)		
10	1	XDFZZ		SMB620685	80063	PLUG, DOUBLE	EA	1
10	2	PAFZZ	6625-00-631-1628	302	83330	PROD, TEST	EA	1
10	3	XDFZZ		30	76545	CLIP, ELECTRICAL	EA	1

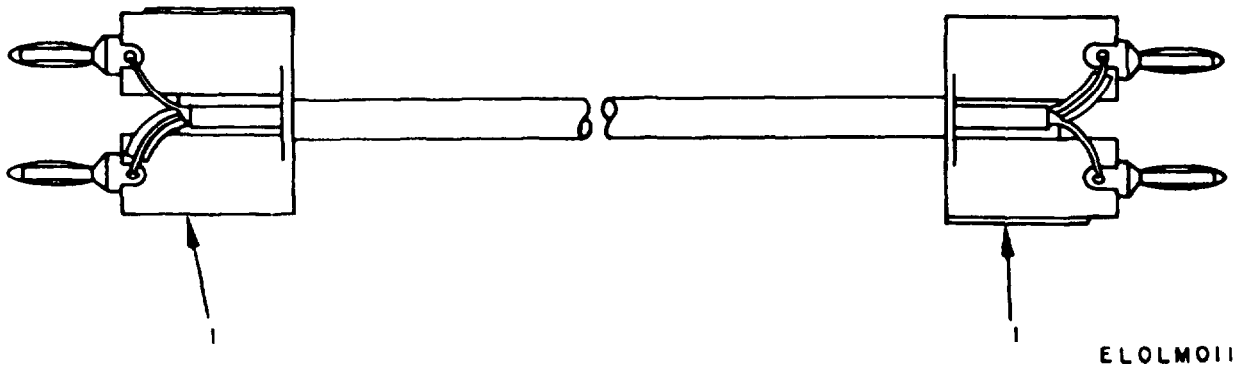

Figure 11. Cable Assembly, Radio Frequency CG-3371/U (W7).

(1) ILLUSTRATION		(2)	(3)	(4)	(5)	(6)	(7)	(8)
(a) FIG NO	(b) ITEM NO	SMR CODE	NATIONAL STOCK NUMBER	PART NUMBER	FSCM	DESCRIPTION USABLE ON CODE	U/M	QTY INC IN UNIT
11	1	PAFZZ	5935-00-665-4394	274MB	24655	GROUP 10 CABLE ASSEMBLY, RADIO FREQUENCY CG-3371/U (W7) PLUG, DOUBLE	EA	2

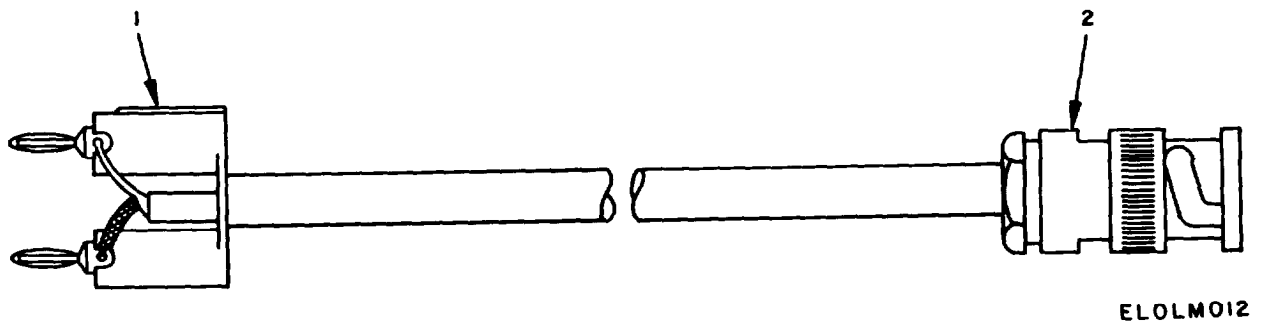
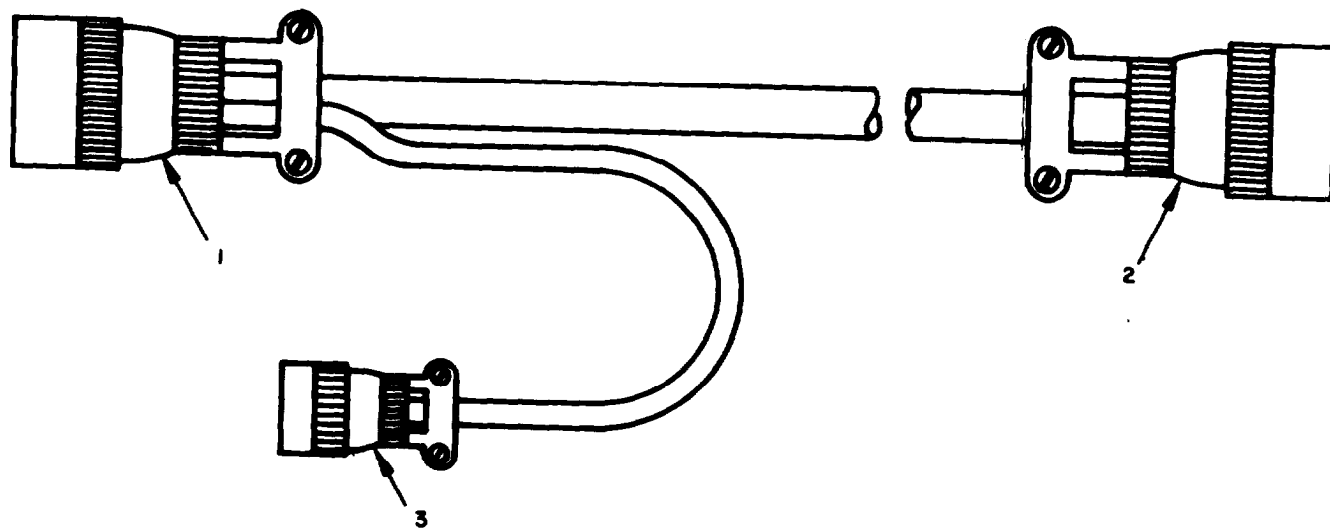

Figure 12. Cable Assembly, Radio Frequency CG-3376/U (W15).

(1) ILLUSTRATION		(2)	(3)	(4)	(5)	(6)	(7)	(8)
(a) FIG NO	(b) ITEM NO	SMR CODE	NATIONAL STOCK NUMBER	PART NUMBER	FSCM	DESCRIPTION USABLE ON CODE	U/M	QTY INC IN UNIT
12	1	XDFZZ		SMB620685	80063	GROUP 11 CABLE ASSEMBLY, RADIO FREQUENCY CG-3376/U (W15) PLUG, DOUBLE	EA	1
12	2	PAFZZ	5935-00-823-0487	MS35168-88E	96906	CONNECTOR, PLUG ELECTRICAL	EA	1



ELOLM013

Figure 13. Cable Assembly, Special Purpose CX-10574/ARC-131.

(1) ILLUSTRATION		(2)	(3)	(4)	(5)	(6)	(7)	(8)
(a) FIG NO	(b) ITEM NO	SMR CODE	NATIONAL STOCK NUMBER	PART NUMBER	FSCM	DESCRIPTION USABLE ON CODE	U/M	QTY INC IN UNIT
						GROUP 12 CABLE ASSEMBLY, SPECIAL PURPOSE CX-10574/ARC-131		
13	1	PAFZZ	5935-00-772-9261	MS3116716-26P	96906	CONNECTOR, PLUG, ELECTRICAL	EA	1
13	2	PAFZZ	5935-00-762-1495	MS3116F12-10S	96906	CONNECTOR, PLUG, ELECTRICAL	EA	1
13	3	PAFZZ	5935-00-903-3513	MS3116F16-26SW	96906	CONNECTOR, PLUG, ELECTRICAL	EA	1

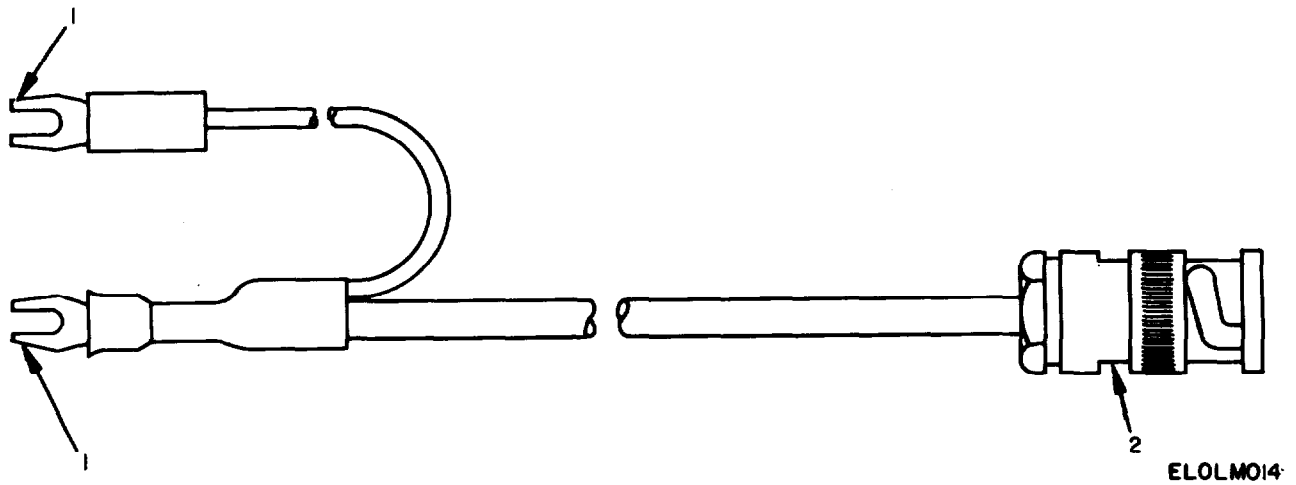

Figure 14. Cable Assembly, Radio Frequency CG-3372/U (W17).

(1) ILLUSTRATION		(2)	(3)	(4)	(5)	(6)	(7)	(8)
(a) FIG NO	(b) ITEM NO	SMR CODE	NATIONAL STOCK NUMBER	PART NUMBER	FSCM	DESCRIPTION USABLE ON CODE	U/M	QTY INC IN ITEM
14	1	XDFZZ		13210	79061	GROUP 13 CABLE ASSEMBLY, RADIO FREQUENCY CG-3372/U (W17)	EA	2
14	2	PAFZZ	5935-00-823-0487	MS35168-88E	96906	CONNECTOR, PLUG, ELECTRICAL	EA	1

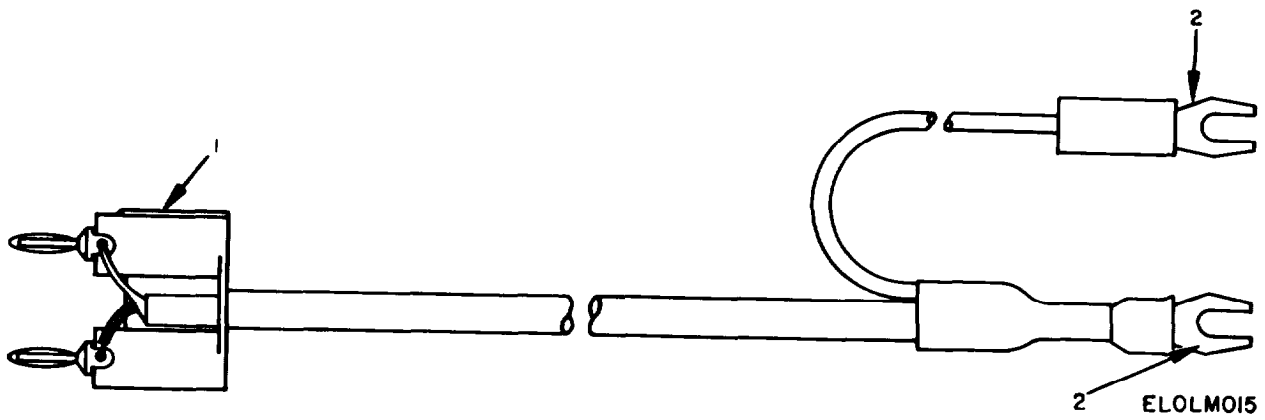

Figure 15. Cable Assembly, Radio Frequency CG-3373/U (W9).

(1) ILLUSTRATION		(2)	(3)	(4)	(3)	(6)	(7)	(8)
(a) FIG NO	(b) ITEM NO	SMR CODE	NATIONAL STOCK NUMBER	PART NUMBER	FSCM	DESCRIPTION USABLE ON CODE	U/M	QTY INC IN UNIT
15	1	PAFZZ	5935-00-665-4394	274-MB	24655	GROUP 14 CABLE ASSEMBLY, RADIO FREQUENCY CG-3373/U (W9) PLUG, DOUBLE	EA	1
15	2	XDFZZ		13210	79061	TERMINAL, LUG	EA	2

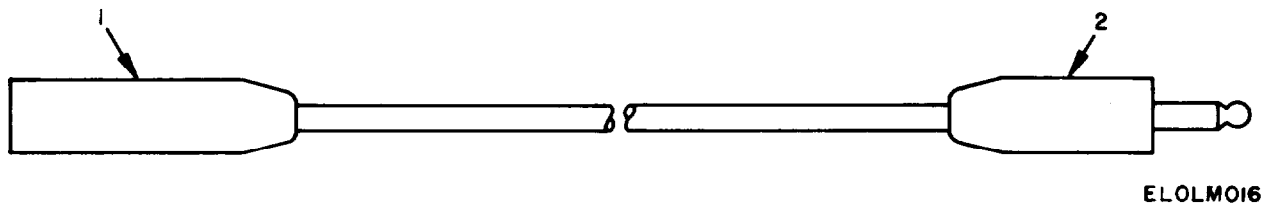
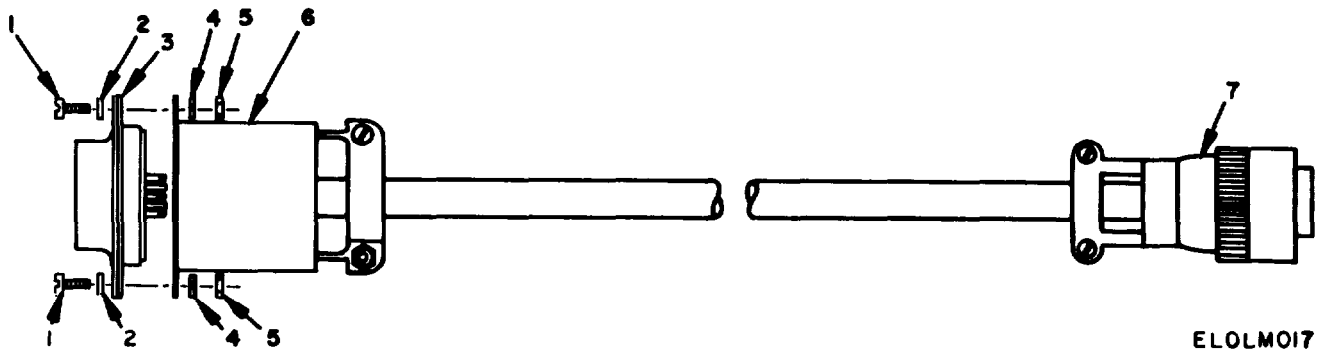

Figure 16. Cord Assembly, Electrical CX-10576/U (W18).

(1) ILLUSTRATION		(2)	(3)	(4)	(5)	(6)	(7)	(8)
(a) FIG NO	(b) ITEM NO	SMR CODE	NATIONAL STOCK NUMBER	PART NUMBER	FSCM	DESCRIPTION USABLE ON CODE	U/M	QTY INC IN UNIT
						GROUP 15 CORD ASSEMBLY, ELECTRICAL CX-10576/U (W18)		
16	1	PAFZZ	5935-00-665-5125	U92AU	81349	JACK,TELEPHONE	EA	1
16	2	PAFZZ	5935-00-642-0626	U93AU	81349	PLUG,TELEPHONE	EA	1



ELOLMO17

Figure 17. Cable Assembly, Special Purpose CX-10571/U (W2).

(1) ILLUSTRATION		(2)	(3)	(4)	(5)	(6)	(7)	(8)
(a) FIG NO	(b) ITEM NO	SMR CODE	NATIONAL STOCK NUMBER	PART NUMBER	FSCM	DESCRIPTION USABLE ON CODE	U/M	QTY INC IN UNIT
						GROUP 16 CABLE ASSEMBLY, SPECIAL PURPOSE CX-10571/U (W2)		
17	1	PAFZZ	5305-00-054-5639	MS51957-5	96906	SCREW, MACHINE	EA	2
17	2	PAFZZ	5310-00-043-4708	NAS620C2	80205	WASHER, FLAT	EA	2
17	3	PAFZZ	5935-00-465-4378	MS4308-1-1	96906	CONNECTOR, RECEPTACLE, ELECTRICAL	EA	1
17	4	PAFZZ	5310-00-928-2690	NAS1640-2	80205	WASHER, LOCK	EA	2
17	5	PAFZZ	5310-00-812-4294	NAS671C2	80205	NUT, PLAIN, HEXAGON	EA	2
17	6	PAFZZ	5935-00-716-6591	DE24657-5	71468	SHIELD, ELECTRICAL, CONNECTOR	EA	1
17	7	PAFZZ	5935-00-762-1504	MS3116F10-6P	96906	CONNECTOR, PLUG, ELECTRICAL	EA	1

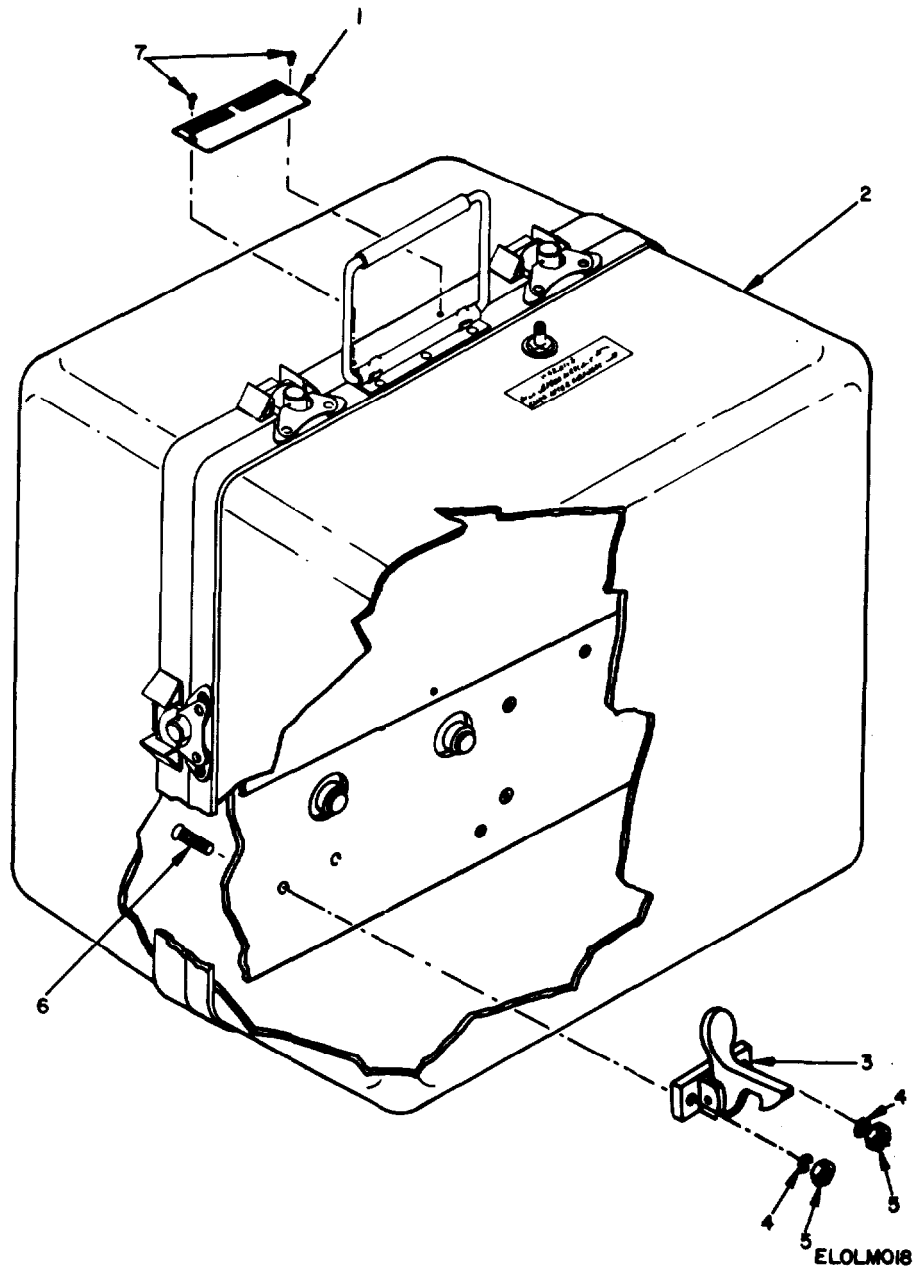
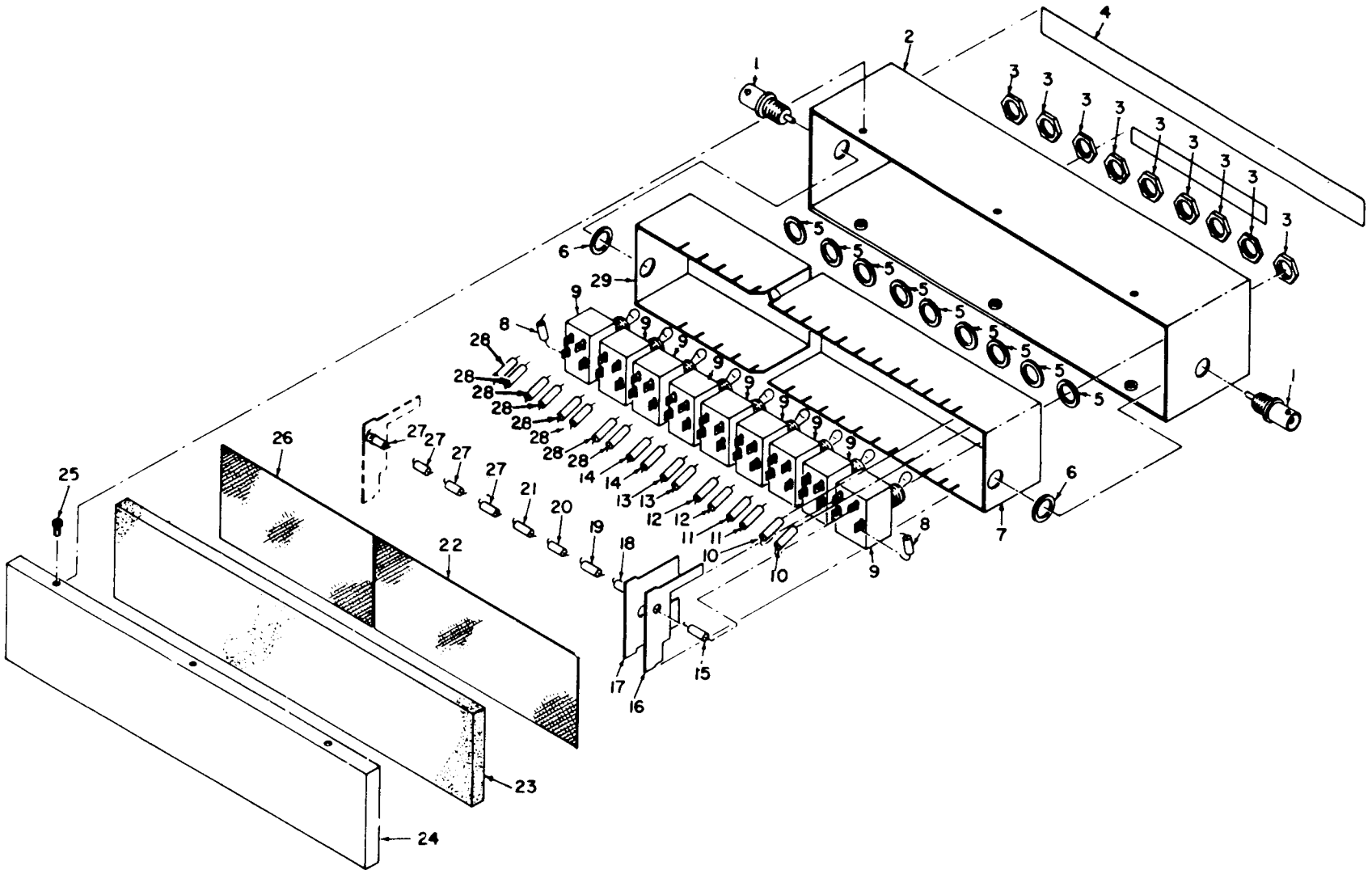

Figure 18. Case, Test Set.

(1) ILLUSTRATION		(2)	(3)	(4)	(5)	(6) DESCRIPTION	(7)	(8)
(a) FIG NO	(b) ITEM NO	SMR CODE	NATIONAL STOCK NUMBER	PART NUMBER	FSCM	USABLE ON CODE	U/M	QTY INC IN UNIT
						GROUP 17 CASE, TEST SET		
18	1	XDFZZ		SMC620734	80063	PLATE, IDENTIFICATION	EA	1
18	2	XDFZZ	5821-00-270-6595	68800	74284	CASE, TEST SET	EA	1
18	3	XDFZZ		2F15	96873	LATCH	EA	1
18	4	XDFZZ		NAS1640-10	80205	WASHER, LOCK	EA	2
18	5	PAFZZ	5310-00-812-4292	NAS671C10	80205	NUT, PLAIN, HEXAGON	EA	2
18	6	PAFZZ	5305-00-781-5664	MS24693C271	96906	SCREW, MACHINE	EA	2
18	7	PAFZZ	5305-00-054-5635	MS51957-1	96906	SCREW, MACHINE	EA	2



ELOLMO19

Figure 19. Variable Attenuator TG-950.

SECTION II		TM11-6625-1610-24P						
(1)	(2)	(3)	(4)	(5)	(6)	(7)	(8)	
ILLUSTRATION					DESCRIPTION	USABLE ON CODE	QTY	
(A)	(B)	NATIONAL	PART	FSCM			INC	
FIG	ITEM	STOCK	NUMBER				IN	
NO	NO	NUMBER	NUMBER				UNIT	
					GROUP 18 VARIABLE ATTENUATOR TG-950			
19	1	XDDZZ	UG625BU	81349	CONNECTOR, RECEPTACLE, ELECTRICAL		EA 2	
19	2	XDDZZ	13-0208-01	04423	CASE, ATTENUATOR		EA 1	
19	3	PADZZ	5940-00-556-7518	96906	NUT, PLAIN, HEXAGON, ELECTRICAL, THIN		EA 9	
19	4	XDDZZ	11-0077-01	04423	DECAL		EA 1	
19	5	XDDZZ	03-1021-01	04423	WASHER, FLAT		EA 9	
19	6	XDDZZ	03-1008-01	04423	WASHER, FLAT		EA 2	
19	7	XDOZZ	15-0031-01	04423	SHIELD, SWITCH		EA 1	
19	8	XDDZZ	22-0009-08	04423	CAPACITOR, FIXED, CERAMIC		EA 2	
19	9	XDDZZ	37-0002-01	04423	SWITCH, TOGGLE		EA 9	
19	10	PADZZ	5905-00-990-5006	81349	RESISTOR, FIXED, FILM		EA 2	
19	11	PADZZ	5905-00-763-4370	81349	RESISTOR, FIXED, FILM		EA 2	
19	12	PADZZ	5905-00-892-7284	81349	RESISTOR, FIXED, FILM		EA 2	
19	13	PADZZ	5905-00-978-7095	81349	RESISTOR, FIXED, FILM		EA 2	
19	14	PADZZ	5905-00-892-7280	81349	RESISTOR, FIXED, FILM		EA 2	
19	15	PADZZ	5905-00-719-4359	81349	RESISTOR, FIXED, FILM		EA 1	
19	16	XDDZZ	15-0029-01	04423	PLATE, ELECTRICAL SHIELD		EA 8	
19	17	XDDZZ	15-0040-01	04423	PLATE, ELECTRICAL SHIELD		EA 9	
19	18	PADZZ	5905-00-071-2840	81349	RESISTOR, FIXED, FILM		EA 1	
19	19	PADZZ	5905-00-988-6282	81349	RESISTOR, FIXED, FILM		EA 1	
19	20	PADZZ	5905-00-988-2174	81349	RESISTOR, FIXED, FILM		EA 1	
19	21	PADZZ	5905-00-078-6763	81349	RESISTOR, FIXED, FILM		EA 1	
19	22	XDDZZ	15-0033-01	04423	SHIELDING, GASKET, ELECTRICAL		EA 1	
19	23	XDDZZ	09-4329-01	04423	PAD, CUSHIONING		EA 1	
19	24	XDDZZ	13-0260-01	04423	COVER		EA 1	
19	25	PADZZ	5305-00-054-5648	96906	SCREW, MACHINE		EA 6	
19	26	XDDZZ	15-0034-01	04423	SHIELDING, GASKET ELECTRICAL		EA 1	
19	27	PADZZ	5905-00-068-5720	81349	RESISTOR, FIXED, FILM		EA 4	
19	28	PADZZ	5905-00-079-4057	81349	RESISTOR, FIXED, FILM		EA 8	
19	29	XDDZZ	15-0032-01	0423	SHIELD, SWITCH		EA 1	

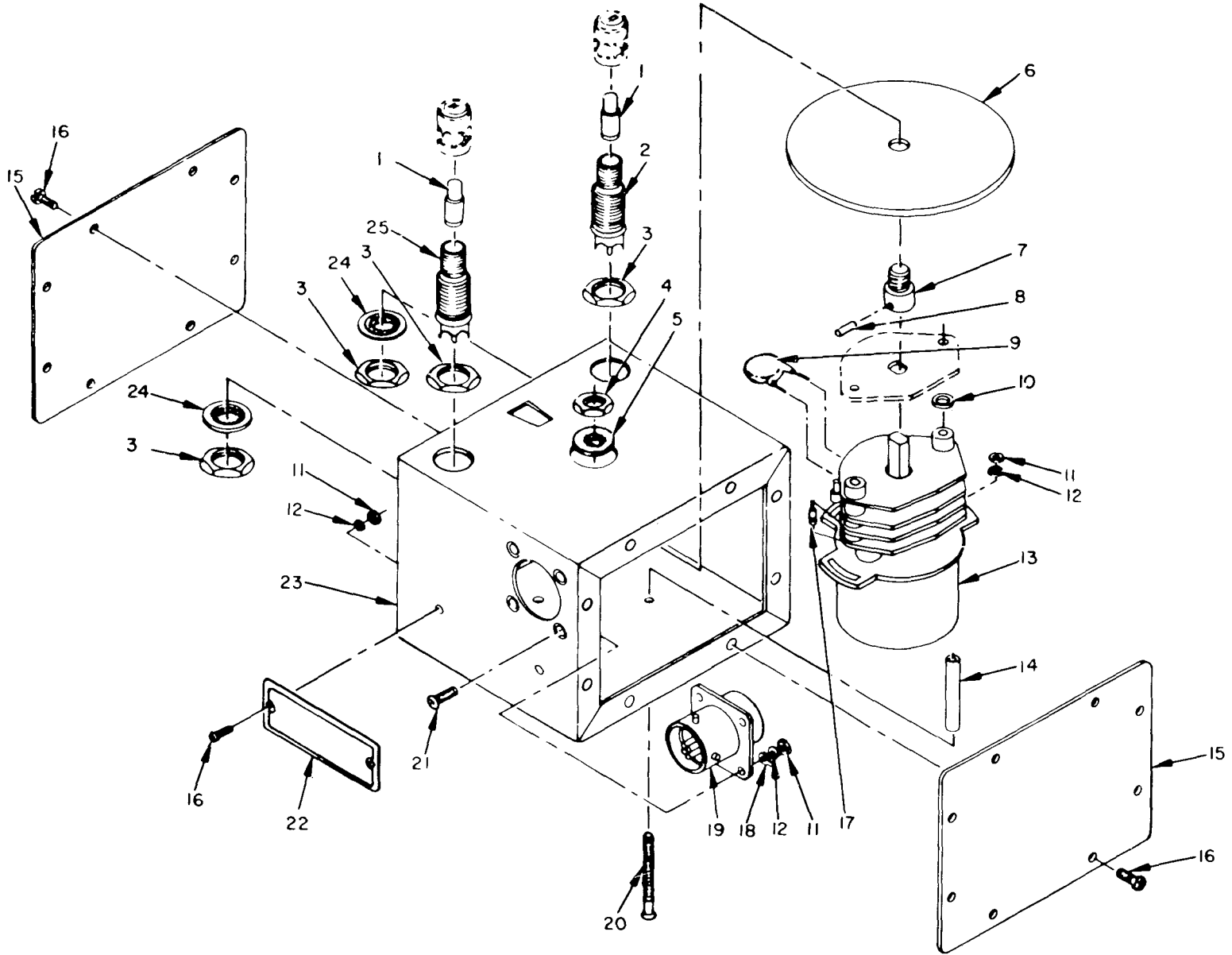

ELOLM020

Figure 20. Simulator, Antenna SM-499/ARC-131.

SECTION II (1) ILLUSTRATION (A) (B) FIG ITEM NO NO		(2) SMR CODE	(3) NATIONAL STOCK NUMBER	(4) PART NUMBER	(5) FSCM	TM11-6625-1610-24P (6) DESCRIPTION	(7) USABLE ON CODE U/M	(8) QTY INC IN UNIT
GROUP 19 SIMULATOR, ANTENNA SM-499/ARC-131								
20	1	PAZZ	6240-00-155-7836	MS25237-327	96906	LAMP, INCANDESCENT	EA	2
20	2	PADZZ	6210-00-519-0448	MS25041-6	96906	LAMPHOLDER	EA	1
20	3	PADZZ	5310-00-596-7681	MS25082-8	96906	NUT, PLAIN, HEXAGON	EA	4
20	4	PADZZ	5310-00-812-4292	NAS671C10	80205	NUT, PLAIN, HEXAGON	EA	1
20	5	PADZZ	5310-00-543-5933	MS35333-73	96906	WASHER, LOCK	EA	1
20	6	PADZZ	5355-00-151-6089	SMC620694	80063	DIAL, FREQUENCY	EA	1
20	7	XDDZZ		SMB620693	80063	HUB, BODY	EA	1
20	8	PADZZ	5315-00-823-8740	MS16562-192	96906	PIN, SPRING	EA	1
20	9	XDDZZ		875-032X5V02037	01939	CAPACITOR, FIXE, CERAMIC	EA	1
20	10	PADZZ	5310-00-782-1349	AN960C4	88044	WASHER, FLAT	EA	6
20	11	PADZZ	5310-00-208-3786	NAS671C4	80205	NUT, PLAIN, HEXAGON	EA	8
20	12	XDDZZ		NAS1640-4	80205	WASHER, LOCK	EA	8
20	13	PADZZ	5945-00-223-5326	SMC620248	80063	RELAY, ROTARY	EA	1
20	14	PADZZ	5365-00-618-9335	NAS43DD0-64	80205	SPACER, SCREW AND BOLT	EA	2
20	15	XDDZZ		SMC620696	80063	COVER, DUMMY ANTENNA COUPLER	EA	2
20	16	PADZZ	5305-00-054-5647	MS51957-13	96906	SCREW, MACHINE	EA	18
20	17	PADZZ	5961-00-087-6047	JAN1N645	81349	SEMICONDUCTOR DEVICE, DIODE	EA	1
20	18	PADZZ	5940-00-682-2477	MS77068-1	96906	TERMINAL, LUG	EA	1
20	19	PADZZ	5935-00-826-1007	MS3112E12-10P	96906	CONNECTOR, RECEPTACLE, ELECTRICAL	EA	1
20	20	PADZZ	5305-00-903-2194	MS24693C14	96906	SCREW, MACHINE	EA	2
20	21	PADZZ	5305-00-225-6400	MS24693C3	96906	SCREW, MACHINE	EA	4
20	22	SDDZZ		SMC620238	80063	PLATE, IDENTIFICATION	EA	1
20	23	XDDZZ		SMB620690	80063	CHASSIS, ELECTRICAL EQUIPMENT	EA	1
20	24	PADZZ	5310-00-257-6215	035692LKW	65597	WASHER, LOCK	EA	2
20	25	PADZZ	6210-00-553-1076	MS25041-7	96906	LAMPHOLDER	EA	1

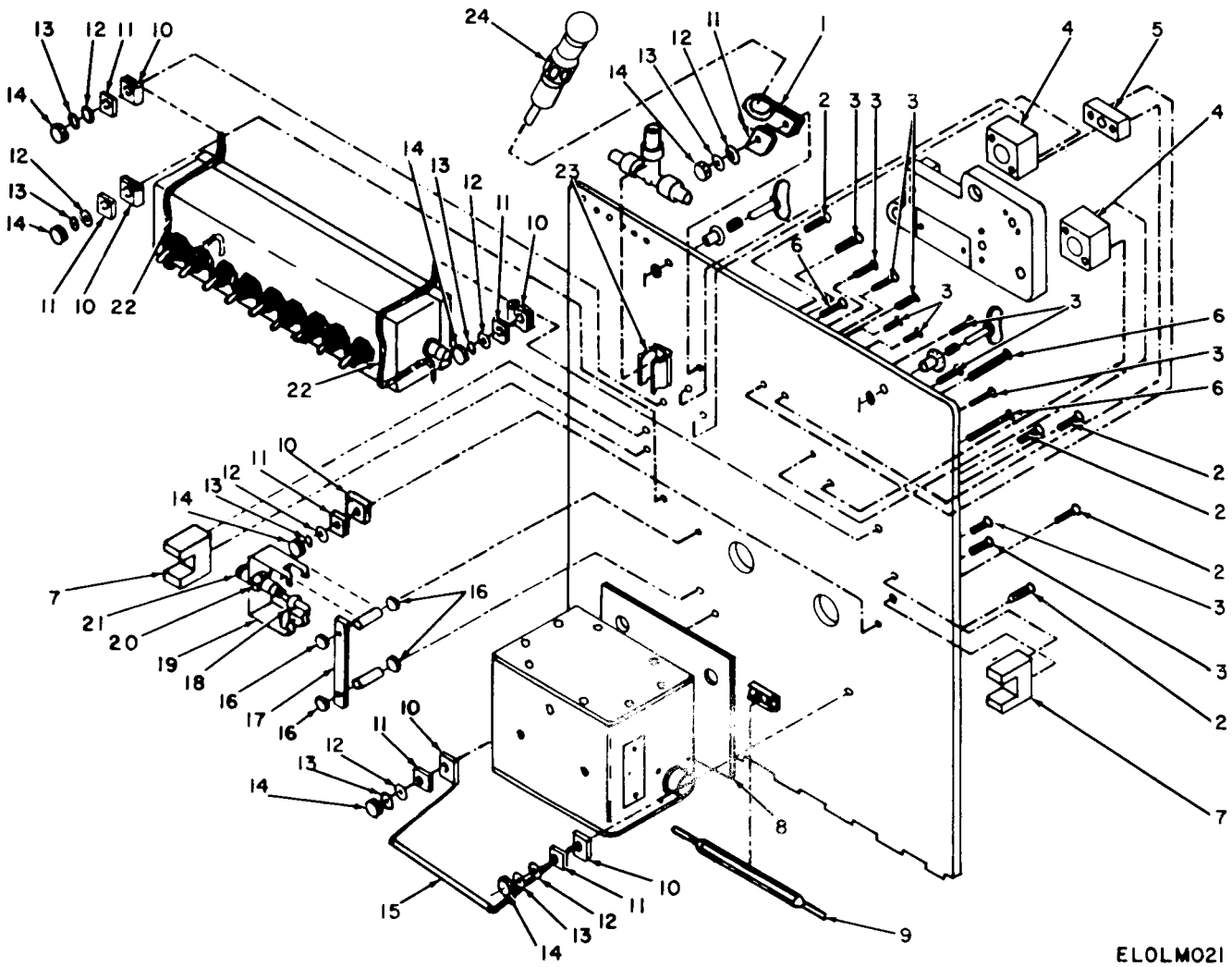

ELOLM021

Figure 21. Test Set, Radio TS-2575/ARC-131, Chassis Exploded View.

SECTION II		TM11-6625-1610-24P						
(1)	(2)	(3)	(4)	(5)	(6)	(7)	(8)	
ILLUSTRATION					DESCRIPTION	USABLE ON CODE	QTY	
(A)	(B)	NATIONAL	PART	FSCM			INC	
FIG	ITEM	STOCK	NUMBER				IN	
NO	NO	NUMBER	NUMBER				UNIT	
					GROUP 20 TEST SET,RADIO TS-2575/ARC-131			
21	1	XDFZZ		NAS1397R10B	80205	CLAMP, LOOP	EA 1	
21	2	PAFZZ	5305-00-844-4371	NAS662C2R6	80205	SCREW, MACHINE	EA 5	
21	3	PAFZZ	5305-00-066-7325	MS24693C5	96906	SCREW, MACHINE	EA 11	
21	4	XDFZZ	5821-00-217-6547	SMB620744	80063	BLOCK, MOUNTING	EA 2	
21	5	PAFZZ	5821-00-215-8284	SMB620743	80063	BLOCK, MOUNTING	EA 1	
21	6	PAFZZ	5305-00-903-2196	MS24693C34	96906	SCREW, MACHINE	EA 2	
21	7	PAFZZ	5821-00-217-6548	SMB620741	80063	GUARD	EA 2	
21	8	PAFZZ	5821-00-217-6549	SMB620742	80063	PAD	EA 1	
21	9	PAFZZ	5120-00-724-3767	5284	73899	ALIGNMENT TOOL, ELECTRICAL EQUIPMENT	EA 1	
21	10	PAFZZ	5340-00-766-6818	NAS1397R2B	80205	CLAMP, LOOP	EA 6	
21	11	PAFZZ	5340-00-416-9292	D6-128	95987	WASHER, LOOP CLAMP	EA 7	
21	12	PAFZZ	5310-00-595-6761	MS15795-802	96906	WASHER, FLAT	EA 7	
21	13	PAFZZ	5310-00-928-2690	NAS1640-2	80205	WASHER, LOCK	EA 7	
21	14	PAFZZ	5310-00-812-4294	NAS671C2	80205	NUT, PLAIN, HEXAGON	EA 7	
21	15	PAFZZ	5340-00-251-7754	SMC620746-2	80063	RETAINER, ELECTRONIC	EA 1	
21	16	PAFZZ	5310-00-616-8660	NAS671C6	80205	NUT, PLAIN, HEXAGON	EA 4	
21	17	XDFZZ		SMB620745	80063	RETAINER, ELECTRICAL CONNECTOR	EA 1	
21	18	XDFZZ		SMB6207050	80063	PLUG, TIP	EA 1	
21	19	XDFZZ		SMC620749	80063	BRACKET, ELECTRICAL CONNECTOR	EA 1	
21	20	SDFZZ		MS35125-2	96906	NUT, PLAIN, HEXAGON	EA 1	
21	21	PAFZZ	5935-00-843-9008	MS35179-1094A	96906	CONNECTOR, RECEPTACLE, ELECTRICAL	EA 1	
21	22	XDFZZ	5340-00-223-5268	SMC620746-1	80063	RETAINER, ELECTRONIC COMPONENT	EA 2	
21	23	XDFZZ		SMC619510-2	80063	CLAMP, LOOP	EA 1	
21	24	PAFZZ	5120-00-832-6628	TL758ARC131	80058	ALIGNMENT TOO, .COUPLER ASSEMBLY	EA 1	

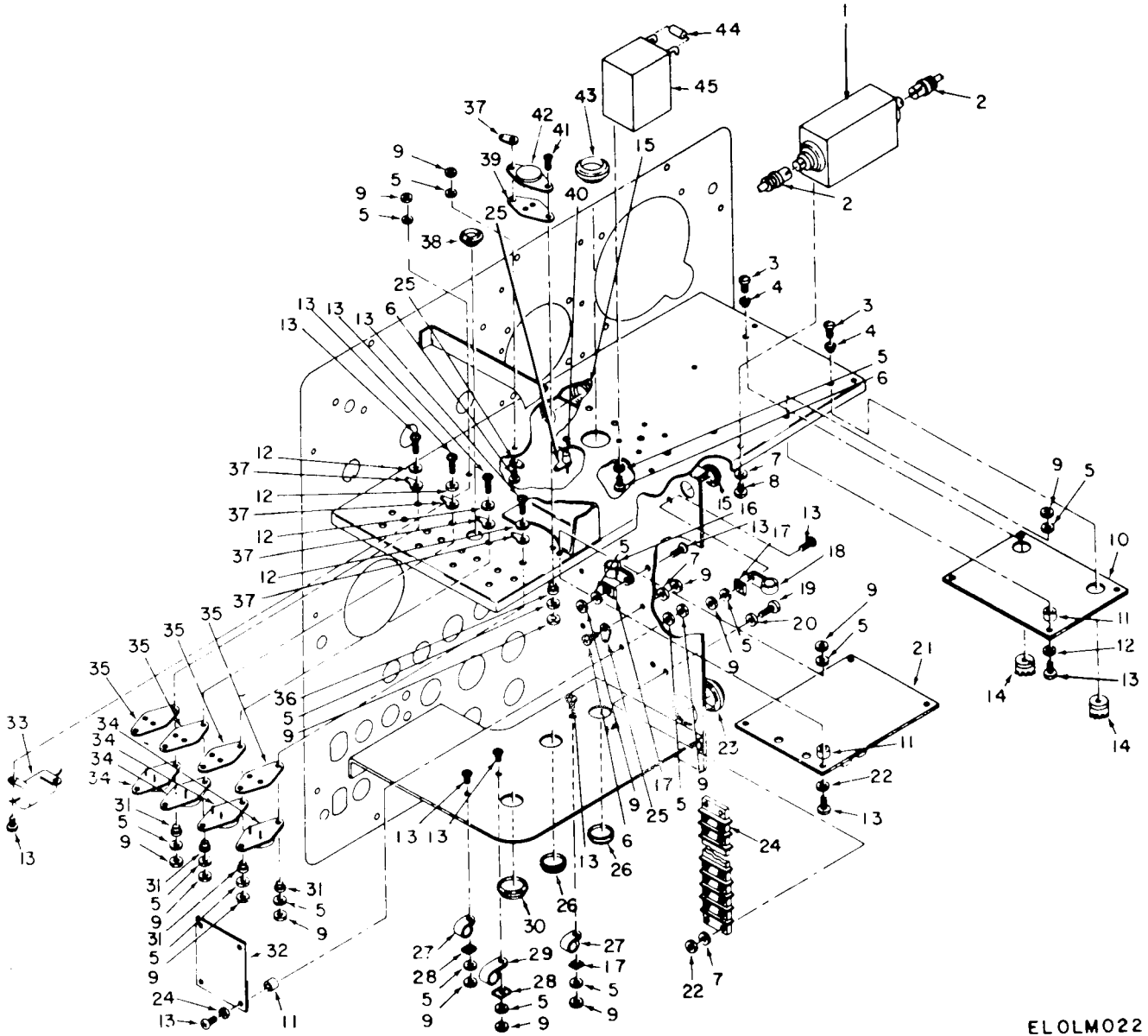
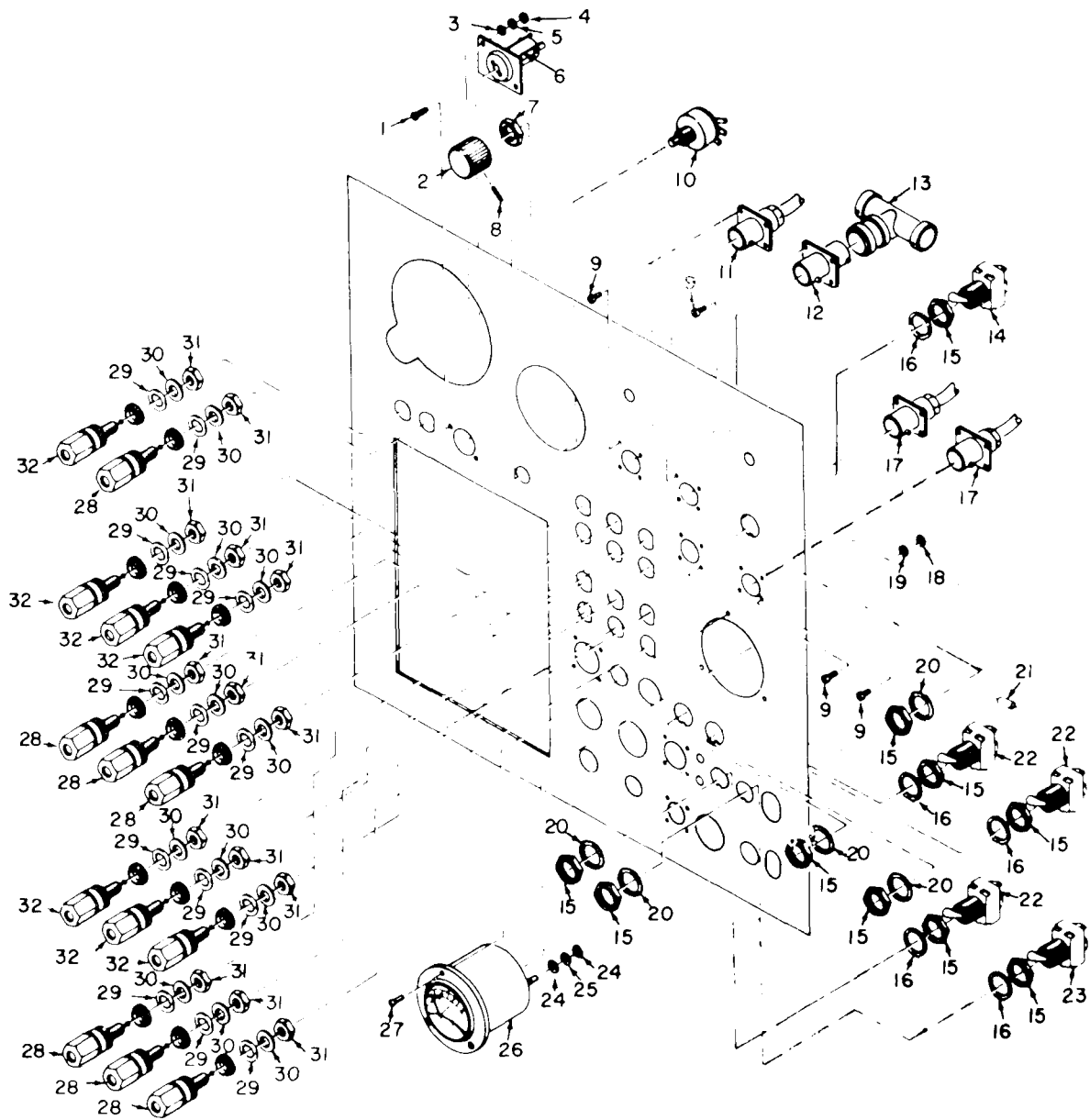

Figure 22. Test Set, Radio TS-2575/ARC-131, Front Panel Rear Exploded View.

SECTION II		TM11-6625-1610-24P						
(1)	(2)	(3)	(4)	(5)	(6)	(7)	(8)	
ILLUSTRATION					DESCRIPTION	USABLE ON CODE	QTY INC IN UNIT	
(A)	(B)	NATIONAL	PART	FSCM		U/M		
FIG	ITEM	STOCK	NUMBER					
NO	NO	NUMBER						
22	1	XDFZZ		8311-20	70998	ATTENUATOR, FIXED	EA 1	
22	2	PAFZZ	5935-00-053-4793	819B1800W	94375	CONNECTOR, PLUG, ELECTRICAL	EA 2	
22	3	PAFZZ	5305-00-206-1270	MS35214-11	96906	SCREW, MACHINE	EA 2	
22	4	XDFZZ		304-004	98978	WASHER, NONMETALLIC	EA 16	
22	5	XDFZZ		NAS1640-4	80205	WASHER, LOCK	EA 17	
22	6	PAFZZ	5305-00-054-5647	MS51957-13	96906	SCREW, MACHINE	EA 3	
22	7	PAFZZ	5310-00-929-6395	NAS1640-6	80205	WASHER, LOCK	EA 5	
22	8	PAFZZ	5305-00-054-6652	MS51957-28	96906	SCREW, MACHINE	EA 1	
22	9	PAFZZ	5310-00-208-3786	NAS671C4	80205	NUT, PLAIN, HEXAGON	EA 16	
22	10	XDFFF	5821-00-089-8206	SMD620649	80063	POWER SUPPLY	EA 1	
22	11	XDFZZ		SMC619644-9	80063	SPACER, SLEEVE	EA 12	
22	12	PAFZZ	5310-00-057-0573	NAS620C4	80205	WASHER, FLAT	EA 8	
22	13	PAFZZ	5305-00-054-5650	MS51957-16	96906	SCREW, MACHINE	EA 13	
22	14	PAFZZ	5999-00-904-3486	TXB2P-032-037	98978	HEAT SINK, ELECTRICAL	EA 2	
22	15	PAFZZ	5325-00-641-2651	NAS557-68	80205	GROMMET, RUBBER	EA 2	
22	16	PAFZZ	5340-00-071-6537	NAS1397R8B	80205	CLAMP, LOOP	EA 2	
22	17	PAFZZ	5310-00-672-2178	D4-128	95987	WASHER, LOOP	EA 3	
22	18	XDFZZ		NAS1397R4B	80205	CLAMP, LOOP	EA 2	
22	19	PAFZZ	5305-00-054-6655	MS51957-31	96906	SCREW, MACHINE	EA 1	
22	20	PAFZZ	5310-00-773-7624	NAS620C6	80205	WASHER, FLAT	EA 1	
22	21	XDFFF	5821-00-089-8207	SMD620642	80063	AUDIO AMPLIFIER	EA 1	
22	22	PAFZZ	5310-00-616-8660	NAS671C6	80205	NUT, PLAIN, HEXAGON	EA 8	
22	23	PAFZZ	5325-00-660-0973	NAS557-10B	80205	GROMMET, RUBBER	EA 1	
22	24	PAFZZ	5940-00-087-6451	37TB12TBLD37	81349	TERMINAL BOARD	EA 1	
22	25	PAFZZ	5940-00-827-2653	MS77068-2	96906	TERMINAL, LUG	EA 3	
22	26	PAFZZ	5325-00-826-1062	NAS557-6C	80205	GROMMER, RUBBER	EA 2	
22	27	XDFZZ		NAS1397R6B	80205	CLAMP, LLOP	EA 2	
22	28	PAFZZ	5340-00-416-9292	D6-128	95987	WASHER, LOOP, CLAMP	EA 2	
22	29	XDFZZ		NAS1397R10B	80205	CLAMP, LOOP	EA 1	
22	30	PAFZZ	5325-00-550-9161	NAS557-10C	80205	GROMMER, RUBBER	EA 1	
22	31	PAFZZ	5970-00-138-8783	SMB620240	80063	BUSHING, SLEEVE	EA 8	
22	32	PAFZZ	5821-00-089-8209	SMB620655	80063	ELECTRONIC COMPONENT ASSEMBLY	EA 1	
22	33	PAFZZ	5905-00-926-8563	RE70N30R9	81349	RESISTOR, FIXE, WIRE WOUND	EA 1	
22	34	PAFZZ	5961-00-917-1636	2N3790	81349	TRANSISTOR	EA 4	
22	35	PAFZZ	5970-00-242-4606	2106103	13209	INSULATOR, TRANSISTOR	EA 4	
22	36	PAFZZ	5970-00-144-7461	SMB619787	80063	INSULATOR, BUSHING	EA 2	
22	37	PAFZZ	5940-00-614-0537	MS35431-1	96906	TERMINAL, LUG	EA 5	
22	38	PAFZZ	5325-00-619-3314	NAS557-4B	80205	GROMMET, RUBBER	EA 1	
22	39	PAFZZ	5970-00-181-0516	SMB619786	80063	INSULATOR, TRANSISTOR	EA 1	
22	40	PAFZZ	5961-00-950-6588	JAN1N3996A	81349	SEMICONDUCTOR DEVICE, DIODE	EA 1	

SECTION II		TM11-6625-1610-24P							
(1)	(2)	(3)	(4)	(5)	(6)	(7)	(8)		
ILLUSTRATION							QTY		
(A)	(B)		NATIONAL		DESCRIPTION		INC		
FIG	ITEM	SMR	STOCK	PART		USABLE ON CODE	IN		
NO	NO	CODE	NUMBER	NUMBER	FSCM		UNIT		
22	41	PAFZZ	5305-00-054-5649	MS51957-15	96906	SCREW,MACHINE	EA	2	
22	42	PAFZZ	5961-00-054-4141	2N3441	81349	TRANSISTOR	EA	1	
22	43	PAFZZ	5325-00-543-4448	NAS557-8B	80205	GROMMET,RUBBER	EA	1	
22	44	PAFZZ	5961-00-082-4073	JAN1N4249	81349	SEMICONDUCTOR DEVICE,DIODE	EA	1	
22	45	PAFZZ	5950-00-216-5912	MT2330	37695	REACTOR	EA	1	



ELOLM023

Figure 23. Test Set, Radio TS-2575/ARC-131, Front Panel Binding Posts and Switches.

SECTION II		TM11-6625-1610-24P						
(1)	(2)	(3)	(4)	(5)	(6)	(7)	(8)	
ILLUSTRATION								
(A)	(B)	NATIONAL	PART	FSCM	DESCRIPTION	USABLE ON CODE	U/M	
FIG	ITEM	STOCK	NUMBER				QTY	
NO	NO	NUMBER	NUMBER				INC	
							IN	
							UNIT	
23	1	PAFZZ	5305-00-054-5648	MS51957-14	96906	SCREW,MACHINE	EA	2
23	2	PAOZZ	5355-00-543-0789	MS91528-1N2B	96906	KNOB	EA	1
23	3	PAFZZ	5310-00-057-0573	NAS620C4	80205	WASHER,FLAT	EA	2
23	4	PAFZZ	5310-00-208-3786	NAS671C4	80205	NUT,PLAIN,HEXAGON	EA	2
23	5	XDFZZ		NAS1640-4	80205	WASHER,LOCK	EA	2
23	6	PAFZZ	5935-00-578-9622	119392	78947	CONNECTOR,RECEPTACLE,ELECTRICAL	EA	1
23	7	PAFZZ	5310-00-241-6604	MS17830-4C	96906	NUT,PLAIN,HEXAGON	EA	1
23	8	PAOZZ	5305-00-206-2080	118341	45413	SETSCREW	EA	1
23	9	XDFZZ		SMB619997-1	80063	SCREW,MACHINE	EA	16
23	10	PAFZZ	5905-00-681-8635	RV4NAYSD253B	81349	RESISTOR,VARIABLE	EA	1
23	11	PAFZZ	5935-00-832-4344	MS35175-291C	96906	CONNECTOR,RECEPTACLE,ELECTRICAL	EA	1
23	12	PAFZZ	5935-00-259-3347	UG414AU	81349	CONNECTOR,RECEPTACLE,ELECTRICAL	EA	1
23	13	PAFZZ	5935-00-683-7892	MS35173-274B	96906	ADAPTER,CONNECTOR	EA	1
23	14	PAFZZ	5930-00-655-1523	MS35058-31	96906	SWITCH,TOGGLE	EA	1
23	15	PAFZZ	5310-00-241-6683	100022-0200	65597	NUT,PLAIN,HEXAGON	EA	10
23	16	PAFZZ	5310-00-543-2740	MS3505823	96906	RING,LOCKING	EA	5
23	17	XDFZZ		SMC620661	80063	CONNECTOR,RECEPTACLE,ELECTRICAL	EA	2
23	18	XDFZZ		4-40NC	81349	NUT,PLAIN,HEXAGON	EA	3
23	19	PAFZZ	5310-00-939-1063	NO. 4,INTERNAL TO OTH	81349	WASHER,LOCK	EA	3
23	20	PAFZZ	5310-00-596-7681	035692LKW	55597	WASHER,LOCK	EA	5
23	21	PAFZZ	5905-00-279-1761	RC20GF621J	81349	RESISTOR,FIXED,COMPOSITION	EA	1
23	22	PAFZZ	5930-00-655-1514	MS35058-22	96906	SWITCH,TOGGLE	EA	3
23	23	PAFZZ	5930-00-655-1515	MS35058-23	96906	SWITCH,TOGGLE	EA	1
23	24	PAFZZ	5310-00-924-8526	1-4-28UNF	81349	NUT,PLAIN,HEXAGON	EA	2
23	25	PAFZZ	5310-00-595-6211	MS15795-803	96906	WASHER,FLAT	EA	1
23	26	PAFZZ	6625-00-643-1800	MR26W050DCVVR	81349	METER,ELECTRICAL INDICATING	EA	1
23	27	PAFZZ	5305-00-054-5652	MS51957-18	96906	SCREW,MACHINE	EA	3
23	28	PAFZZ	5940-00-269-2220	PB01FA03	81349	POST,BINDING	EA	7
23	29	SDFZZ		NAS164012	80205	WASHER,LOCK	EA	14
23	30	XDFZZ		NAS671C11	80205	WASHER,FLAT	EA	14
23	31	XDFZZ		9062928	18876	NUT,PLAIN,HEXAGON	EA	14
23	32	PAFZZ	5940-00-269-2219	PB01FA04	81349	POST,BINDING	EA	7

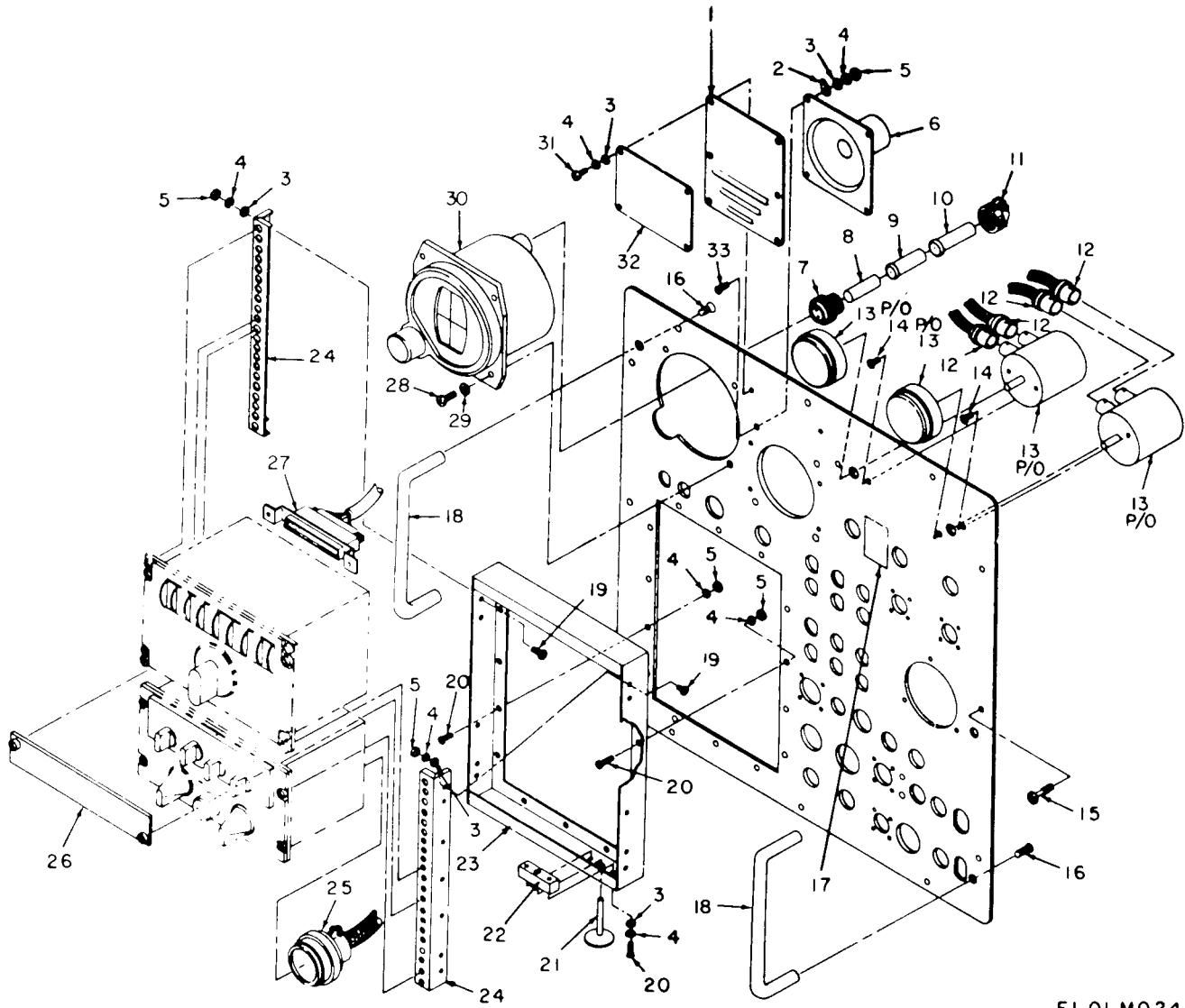

ELOLM024

Figure 24. Test Set, Radio TS-2575/ARC-131,
Front Panel Major Components Exploded.

SECTION II		TM11-6625-1610-24P						
(1)	(2)	(3)	(4)	(5)	(6)	(7)	(8)	
ILLUSTRATION					DESCRIPTION	USABLE ON CODE	QTY INC IN UNIT	
(A)	(B)	NATIONAL	PART	FSCM		U/M		
FIG	ITEM	STOCK	NUMBER					
NO	NO	NUMBER						
24	1	XDFZZ	SMC620663	80063	COVER, LOUDSPEAKER	EA	1	
24	2	PAFZZ	5940-00-827-2653	MS77068-2	96906	TERMINAL, LUG	EA 1	
24	3	PAFZZ	5310-00-057-0573	NAS620C4	80205	WASHER, FLAT	EA 14	
24	4	XDFZZ	NAS1640-4	80205	WASHER, LOCK	EA	14	
24	5	PAFZZ	5310-00-208-3786	NAS671C4	80205	NUT, PLAIN, HEXAGON	EA 10	
24	6	PAFZZ	5965-00-021-2540	SMC620662	80063	LOUDSPEAKER, PERMANENT MAGNET	EA 1	
24	7	PAFZZ	5935-00-557-1284	MS3106E18-1SC	96906	CONNECTOR, PLUG, ELECTRICAL	EA 1	
24	8	PAFZZ	5365-00-663-2125	AN3420-10	88044	BUSHING, ELECTRICAL CONDUCTOR	EA 1	
24	9	PAFZZ	5365-00-828-8526	AN3420-6A	88044	BUSHING, ELECTRICAL CONDUCTOR	EA 1	
24	10	PAFZZ	5365-00-141-6944	AN 3420-8	88044	BUSHING, ELECTRICAL CONDUCTOR	EA 1	
24	11	PAFZZ	5935-00-809-0786	MS3057-10A	96906	CLAMP, LOOP	EA 1	
24	12	PAFZZ	5935-00-823-0487	MS35168-88E	96906	CONNECTOR, PLUG, ELECTRICAL	EA 4	
24	13	PAFZZ	5985-00-878-7943	RA-50	23042	ATTENUATOR, VARIABLE	EA 2	
24	14	PAFZZ	5305-00-889-2991	MS24693C48	96906	SCREW, MACHINE	EA 4	
24	15	PAFZZ	5305-00-151-6199	SMB620711	80063	SCREW, EXTERNALLY RELIEVED BODY	EA 12	
24	16	PAFZZ	5305-00-051-0227	MS24693C272	96906	SCREW, MACHINE	EA 4	
24	17	XDFZZ	SMC620697	80063	DECAL	EA	1	
24	18	PAFZZ	5340-00-840-0954	MS39087-4	96906	HANDLE, BOW	EA 2	
24	19	PAFZZ	5305-00-054-5649	MS51957-15	96906	SCREW, MACHINE	EA 8	
24	20	PAFZZ	5305-00-054-5650	MS51957-16	96906	SCREW, MACHINE	EA 10	
24	21	XDFZZ	SMB620703	80063	BOLT	EA	1	
24	22	XDFZZ	SMC620702	80063	BLOCK, NUT	EA	1	
24	23	XDFZZ	SMD620640	80063	FRAME, MOUNTING, TEST SET ASSEMBLY	EA	1	
24	24	PAFZZ	5325-00-213-2375	PR31/2-6.375	72793	RECEPTACLE STRIP, FASTENER	EA 2	
24	25	PAFZZ	5935-00-913-1818	MS3116F24-61S	96906	CONNECTOR, PLUG, ELECTRICAL	EA 1	
24	26	XDFZZ	SMB620665	80063	PANEL, BLANK	EA	1	
24	27	XDFZZ	SMD620250	80063	CONNECTOR, ASSEMBLY, SPECIAL PURPOSE	EA	1	
24	28	PAFZZ	5305-00-054-6656	MS51957-32	96906	SCREW, MACHINE	EA 4	
24	29	PAFZZ	5310-00-722-5998	MS15795-805	96906	WASHER, FLAT	EA 4	
24	30	PAFDL	6610-00-839-8638	ID48ARN	80058	INDICATOR	EA 1	
24	31	PAFZZ	5305-00-054-5648	MS51957-14	96906	SCREW, MACHINE	EA 4	
24	32	XDFZZ	SMD620733	80063	PLATE, IDENTIFICATION	EA	1	
24	33	PAFZZ	5305-00-066-7325	MS24693C5	96906	SCREW, MACHINE	EA 4	

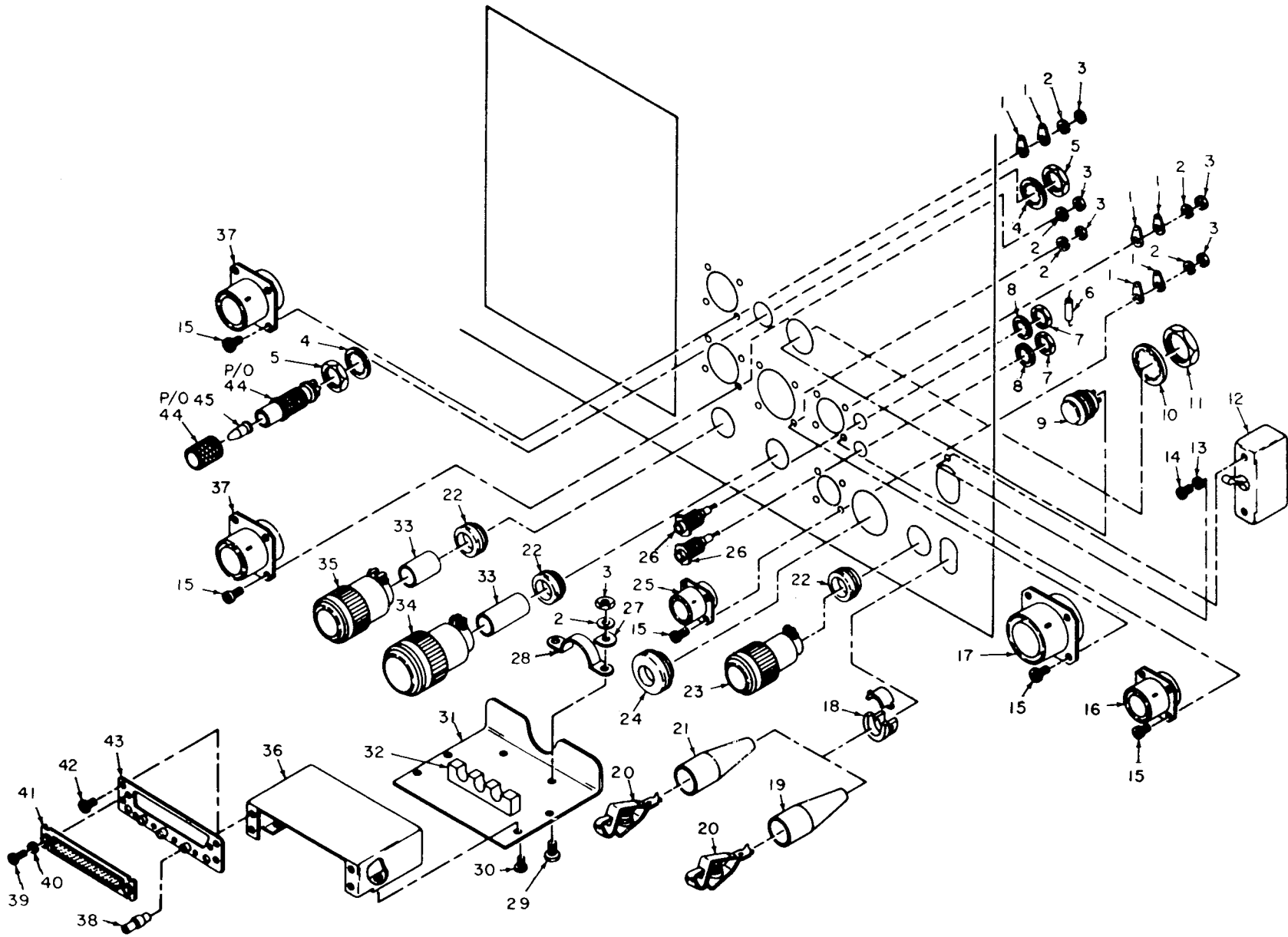

ELOLM025

Figure 25. Test Set, Radio TS-2575/ARC-131, Front Panel, Lower Right.

SECTION II		TM11-6625-1610-24P						
(1)	(2)	(3)	(4)	(5)	(6)	(7)	(8)	
ILLUSTRATION					DESCRIPTION	USABLE ON CODE	QTY INC IN UNIT	
(A)	(B)	NATIONAL	PART	FSCM		U/M		
FIG	ITEM	STOCK	NUMBER					
NO	NO	NUMBER	NUMBER					
25	1	PAFZZ 5940-00-827-2653	MS77068-2	96906	TERMINAL, LUG	EA	6	
25	2	XDFZZ	NAS1640-4	80205	WASHER, LOCK	EA	7	
25	3	PAFZZ 5310-00-208-3786	NAS671C4	80205	NUT, PLAIN, HEXAGON	EA	7	
25	4	PAFZZ 5310-00-596-7681	035692LKW	55597	WASHER, LOCK	EA	2	
25	5	PAFZZ 5310-00-721-8000	MS25082-8	96906	NUT, PLAIN, HEXAGON	EA	2	
25	6	PAFZZ 5905-00-045-5422	RW69VR10	81349	RESISTOR, FIXED, WIRE WOUND	EA	1	
25	7	PAFZZ 5310-00-241-6604	MS17830-4C	96906	NUT, PLAIN, HEXAGON	EA	2	
25	8	PAFZZ 5310-00-933-8118	MS35338-135	96906	WASHER, LOCK	EA	2	
25	9	PAFZZ 5930-00-581-4115	MS25089-4GR	96906	SWITCH, PUSH	EA	1	
25	10	PAFZZ 5310-00-011-6123	MS35338-69	96906	WASHER, LOCK	EA	1	
25	11	PAFZZ 5310-00-854-9382	MS25082B11	96906	NUT, PLAIN, HEXAGON	EA	1	
25	12	PAFZZ 5925-00-929-7273	MS25304-5	96906	CIRCUIT, BREAKER	EA	1	
25	13	PAFZZ 5310-00-773-7624	NAS620C6	80205	WASHER, FLAT	EA	2	
25	14	PAFZZ 5305-00-054-6652	MS51957-28	96906	SCREW, MACHINE	EA	2	
25	15	PAFZZ 5305-00-054-5649	MS51957-15	96906	SCREW, MACHINE	EA	12	
25	16	PAFZZ 5935-00-902-2338	MS3110E10-6S	96906	CONNECTOR, RECEPTACLE, ELECTRICAL	EA	1	
25	17	PAFZZ 5935-00-827-1545	MS3112E16-26S	96906	CONNECTOR, RECEPTACLE, ELECTRICAL	EA	1	
25	18	PAFZZ 5975-00-241-9683	SR-6P	28520	INSULATOR, BUSHING	EA	1	
25	19	XDFZZ	SMB620668-1	80063	CABLE NIPPLE, ELECTRICAL	EA	1	
25	20	PAFZZ 5940-00-204-8350	24A	76545	CLIP, ELECTRICAL	EA	2	
25	21	XDFZZ	SMB620668-2	80063	CABLE NIPPLE, ELECTRICAL	EA	1	
25	22	PAFZZ 5325-00-582-3601	MS35489-38	96906	GROMMET, RUBBER	EA	3	
25	23	PAFZZ 5935-00-762-1495	MS3116F12-10S	96906	CONNECTOR, PLUG, ELECTRICAL	EA	1	
25	24	PAFZZ 5325-00-174-9332	MS35489-48	96906	GROMMET, RUBBER	EA	1	
25	25	XDFZZ 5935-00-825-8860	MS3112E8-4S	96906	CONNECTOR, RECEPTACLE, ELECTRICAL	EA	1	
25	26	PAFZZ 5935-00-685-9396	MS16108-1A	96906	JACK, TIP	EA	2	
25	27	PAFZZ 5310-00-672-2178	D4-128	95987	WASHER, LOOP CLAMP	EA	2	
25	28	PAFZZ 5340-00-071-6537	NAS1397R8B	80205	CLAMP, LOOP	EA	1	
25	29	PAFZZ 5305-00-066-7325	MS24693C5	96906	SCREW, MACHINE	EA	4	
25	30	PAFZZ 5305-00-056-9961	MS24693C4	96906	SCREW, MACHINE	EA	4	
25	31	XDFZZ	SMC620672	80063	SHELL, ELECTRICAL CONNECTOR	EA	1	
25	32	XDFZZ 5970-00-138-8800	SMB620735	80063	SPACER	EA	1	
25	33	PAFZZ 5365-00-828-8526	AN3420-6A	88044	BUSHING, ELECTRICAL CONDUCTOR	EA	2	
25	34	PAFZZ 5935-00-772-9261	MS3116F16-26P	96906	CONNECTOR, PLUG, ELECTRICAL	EA	1	
25	35	PAFZZ 5935-00-835-4861	MS3116E12-10P	96906	CONNECTOR, PLUG, ELECTRICAL	EA	1	
25	36	XDFZZ	SMB620674	80063	COVER, ELECTRICAL CONNECTOR	EA	1	
25	37	PAFZZ 5935-00-826-1020	MS3112E12-10S	96906	CONNECTOR, RECEPTACLE, ELECTRICAL	EA	2	
25	38	PAFZZ 5999-00-728-3617	DM53742-5004	71468	CONTACT, ELECTRICAL SNAP-IN	EA	3	
25	39	PAFZZ 5305-00-054-5636	MS51957-2	96906	SCREW, MACHINE	EA	2	

SECTION II		TM11-6625-1610-24P						
(1)	(2)	(3)	(4)	(5)	(6)	(7)	(8)	
ILLUSTRATION							QTY	
(A)	(B)	NATIONAL			DESCRIPTION		INC	
FIG	ITEM	STOCK	PART	FSCM		USABLE ON CODE	IN	
NO	NO	NUMBER	NUMBER				UNIT	
25	40	PAFZZ 5310-00-928-2690	NAS1640-2	80205	WASHER, LOCK	EA	2	
25	41	PAFZZ 5935-00-904-1373	DDMF-50S	71468	CONNECTOR, RECEPTACLE, ELECTRICAL	EA	1	
25	42	PAFZZ 5305-00-054-5647	MS51957-13	96906	SCREW, MACHINE	EA	4	
25	43	PAFZZ 5935-00-897-2074	SMC620671	80063	PLATE, MOUNTING, CONNECTOR	EA	1	
25	44	PAFZZ 6210-00-519-0448	MS25041-6	96906	LAMPHOLDER	EA	1	
25	45	PAOZZ 6240-00-155-7836	MS25237-327	96906	LAMP, INCANDESCENT	EA	1	

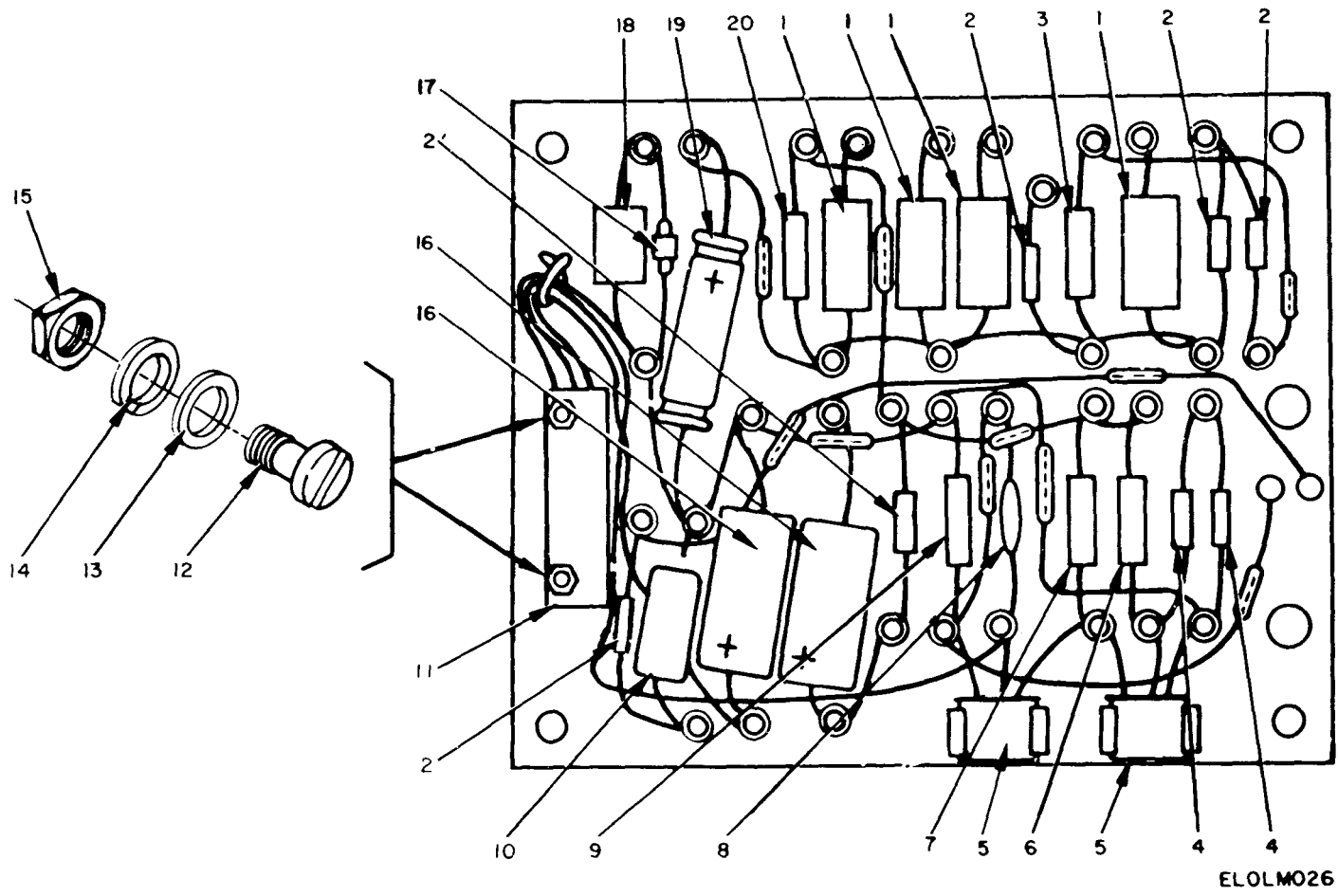
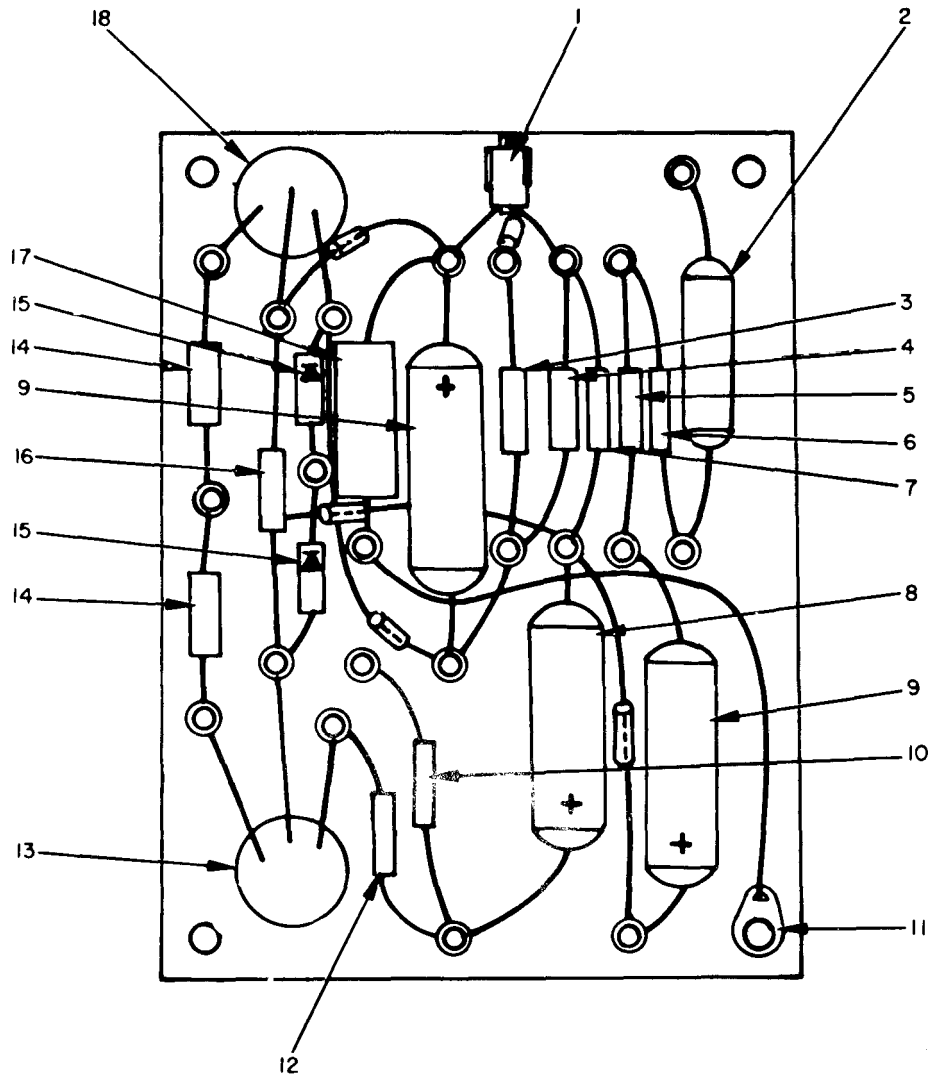

Figure 26. Power Supply SMD620649.

SECTION II						TM11-6625-1610-24P		
(1)	(2)	(3)	(4)	(5)	(6)	(7)	(8)	
ILLUSTRATION								
(A)	(B)	NATIONAL			DESCRIPTION		QTY	
FIG	ITEM	STOCK	PART	FSCM		USABLE ON CODE	INC	
NO	NO	NUMBER	NUMBER				IN	
							UNIT	
					GROUP 2001 POWER SUPPLY SMD620649			
26	1	PAFZZ 5905-00-051-5557	RW69VR47	81349	RESISTOR, FIXED, WIRE WOUND		EA 4	
26	2	PAFZZ 5961-00-087-6047	JAN1N645	81349	SEMICONDUCTOR DEVICE, DIODE		EA 5	
26	3	PAFZZ 5905-00-106-9344	RC20GF101J	81349	RESISTOR, FIXED, COMPOSITION		EA 1	
26	4	PAFZZ 5961-00-995-2310	JAN1N752A	81349	SEMICONDUCTOR DEVICE, DIODE		EA 2	
26	5	PAFZZ 5961-00-855-1551	JAN2N1132	81349	TRANSISTOR		EA 2	
26	6	PAFZZ 5905-00-279-1757	RC20GF152J	81349	RESISTOR, FIXED, COMPOSITION		EA 1	
26	7	PAFZZ 5905-00-104-8337	RC20GF751J	81349	RESISTOR, FIXED, COMPOSITION		EA 1	
26	8	PAFZZ 5910-00-087-6280	SMC619657-2	80063	CAPACITOR, FIXED, CERAMIC		EA 1	
26	9	PAFZZ 5905-00-190-8887	RC20GF202J	81349	RESISTOR, FIXED, COMPOSITION		EA 1	
26	10	PAFZZ 5905-00-061-2089	RW69V510	81349	RESISTOR, FIXED, WIRE WOUND		EA 1	
26	11	PAFZZ 5905-00-052-1794	RT10C2L102	81349	RESISTOR, ADJUSTABLE		EA 1	
26	12	PAFZZ 5305-00-054-5640	MS51957-6	96906	SCREW, MACHINE		EA 2	
26	13	PAFZZ 5310-00-043-4708	NAS620C2	80205	WASHER, FLAT		EA 2	
26	14	PAFZZ 5310-00-928-2690	NAS1640-2	80205	WASHER, LOCK		EA 2	
26	15	PAFZZ 5310-00-812-4294	NAS67102	80205	NUT, PLAIN, HEXAGON		EA 2	
26	16	PAFZZ 5910-00-926-8217	M26655-2-0204	81349	CAPACITOR, FIXED, ELECTROLYTIC		EA 2	
26	17	PAFZZ 5961-00-937-7375	1N4143	81349	SEMICONDUCTOR DEVICE, DIODE		EA 1	
26	18	PAFZZ 5961-00-842-9621	SMC619789	80063	SEMICONDUCTOR DEVICE, DIODE		EA 1	
26	19	PAFZZ 5910-00-051-4996	CL25BN080SP3	81349	CAPACITOR, FIXED, ELECTROLYTIC		EA 1	
26	20	PAFZZ 5905-00-279-1751	RC20GF302J	81349	RESISTOR, FIXED, COMPOSITION		EA 1	



ELOLM027

Figure 27. Audio Amplifier SMD620642.

SECTION II		TM11-6625-1610-24P						
(1)	(2)	(3)	(4)	(5)	(6)	(7)	(8)	
ILLUSTRATION								
(A)	(B)	NATIONAL			DESCRIPTION		QTY	
FIG	ITEM	STOCK	PART	FSCM		USABLE ON CODE	INC	
NO	NO	NUMBER	NUMBER				IN	
							UNIT	
					GROUP 2002 AUDIO AMPLIFIER SMD620642			
27	1	PAFZZ	5961-00-911-6185	JAN2N914	81349		EA 1	
27	2	PAFZZ	5910-00-134-9615	CL23CJ1R5TN3	81349		EA 1	
27	3	PAFZZ	5905-00-106-9344	RC20GF101J	81349		EA 1	
27	4	PAFZZ	5905-00-249-4200	RC20GF912J	81349		EA 1	
27	5	PAFZZ	5905-00-249-3656	RC20GF623J	81349		EA 1	
27	6	PAFZZ	5905-00-279-2673	RC20GF622J	81349		EA 1	
27	7	PAFZZ	5905-00-279-3500	RC20GF183J	81348		EA 1	
27	8	PAFZZ	5910-00-057-5218	CL25BJ180TP3	81349		EA 1	
27	9	PAFZZ	5910-00-865-3297	CL21CB400UP3	81349		EA 2	
27	10	PAFZZ	5905-00-171-1999	RC20GF821J	81349		EA 1	
27	11	PAFZZ	5940-00-614-0537	MS35431-1	96906		EA 1	
27	12	PAFZZ	5905-00-171-2006	RC20GF271J	81349		EA 1	
27	13	PAFZZ	5961-00-837-7262	JAN2N697	81349		EA 1	
27	14	XDFZZ		RC20GF483J	81349		EA 2	
27	15	PAFZZ	5961-00-995-2310	JAN1N752A	81349		EA 2	
27	16	PAFZZ	5905-00-279-2674	RC20GF201J	81349		EA 1	
27	17	PAFZZ	5910-00-158-5367	CK16AX473M	81349		EA 1	
27	18	PAFZZ	5961-00-855-1551	JAN2N1132	81349		EA 1	

NOTE: LATEST NATIONAL STOCK NUMBER AND PART NUMBER ASSIGNMENTS ARE INCLUDED AT END OF INDEX

STOCK NUMBER	FIGURE NO	ITEM NO	STOCK NUMBER	FIGURE NO	ITEM NO
5310-00-011-6123	25	10	5310-00-208-3786	20	11
5965-00-021-2540	24	6	5310-00-208-3786	22	9
5310-00-043-4708	17	2	5310-00-208-3786	23	4
5310-00-043-4708	26	13	5310-00-208-3786	24	5
5905-00-045-5422	25	6	5310-00-208-3786	25	3
5305-00-051-0227	24	16	5325-00-213-2375	24	24
5905-00-051-5557	26	1	5821-00-215-8284	21	5
5905-00-052-1794	26	11	5950-00-216-5912	22	45
5935-00-053-4793	8	1	5821-00-217-6547	21	4
5935-00-053-4793	9	1	5821-00-217-6548	21	7
5935-00-053-4793	22	2	5821-00-217-6549	21	8
5305-00-054-5635	18	7	5340-00-223-5268	21	22
5305-00-054-5636	25	39	5945-00-223-5326	20	13
5305-00-054-5637	2	17	5305-00-225-6400	20	21
5305-00-054-5639	17	1	5310-00-241-6604	23	7
5305-00-054-5640	26	12	5310-00-241-6604	25	7
5305-00-054-5647	20	16	5310-00-241-6683	23	15
5305-00-054-5647	22	6	5975-00-241-9683	25	16
5305-00-054-5647	25	42	5970-00-242-4606	22	35
5305-00-054-5648	2	14	5905-00-249-3656	27	5
5305-00-054-5648	23	1	5905-00-249-4200	27	4
5305-00-054-5648	24	33	5340-00-251-7754	21	15
5305-00-054-5649	22	41	5310-00-257-6215	20	24
5305-00-054-5649	24	19	5935-00-259-3347	23	12
5305-00-054-5649	25	15	5940-00-269-2219	23	32
5305-00-054-5650	22	13	5940-00-269-2220	23	28
5305-00-054-5650	24	20	5821-00-270-6595	18	2
5305-00-054-5652	23	27	5905-00-279-1751	26	20
5305-00-054-6652	22	8	5905-00-279-1757	26	6
5305-00-054-6652	25	14	5905-00-279-1761	23	21
5305-00-054-6655	22	19	5905-00-279-2673	27	6
5305-00-054-6656	24	30	5905-00-279-2674	27	16
5305-00-056-9961	2	8	5905-00-279-3500	27	7
5305-00-056-9961	25	30	5340-00-416-9292	21	11
5310-00-057-0573	22	12	5340-00-416-9292	22	28
5310-00-057-0573	23	3	5935-00-465-4378	17	3
5310-00-057-0573	24	3	5935-00-493-0466	2	15
5910-00-057-5218	27	8	6210-00-519-0448	20	2
5905-00-061-2089	26	10	6210-00-519-0448	25	44
5120-00-065-2761	1	21	5355-00-543-0789	23	2
5305-00-066-7325	2	7	5310-00-543-2740	23	16
5305-00-066-7325	21	3	5310-00-543-5933	20	5
5305-00-066-7325	24	35	5325-00-550-9161	22	30
5305-00-066-7325	25	29	6210-00-553-1076	20	25
5905-00-068-5720	19	27	5940-00-556-7518	19	3
5905-00-071-2840	19	18	5935-00-557-1284	24	7
5340-00-071-6537	2	5	5935-00-578-9622	23	6
5340-00-071-6537	22	16	5930-00-581-4115	25	9
5340-00-071-6537	25	28	5325-00-582-3601	25	22
5985-00-075-3482	1	24	5310-00-595-6211	23	25
5905-00-078-6763	19	21	5310-00-595-6761	21	12
5905-00-079-4057	19	28	5310-00-596-7681	20	3
5961-00-082-4073	22	44	5310-00-596-7681	23	20
5961-00-087-6047	20	17	5310-00-596-7681	25	4
5961-00-087-6047	26	2	5940-00-614-0537	22	37
5910-00-087-6280	26	8	5940-00-614-0537	27	11
5935-00-087-6290	8	2	5310-00-616-8660	21	16
5940-00-087-6451	22	24	5310-00-616-8660	22	22
5935-00-089-8060	1	20	5325-00-619-3314	22	38
5821-00-089-8206	22	10	6625-00-631-1628	10	2
5821-00-089-8207	22	21	5325-00-641-2651	22	15
5821-00-089-8209	22	32	5935-00-642-0626	16	2
5970-00-138-8783	22	31	6625-00-643-1800	23	26
5970-00-138-8798	2	9	5930-00-655-1514	23	22
5970-00-138-8800	2	10	5930-00-655-1515	23	23
5970-00-138-8800	25	32	5930-00-655-1523	23	14
5365-00-141-6944	24	10	5365-00-663-2125	24	8
5970-00-144-7461	22	36	5935-00-665-4394	11	1
5355-00-151-6089	20	6	5935-00-665-4394	15	1
5305-00-151-6199	24	15	5935-00-665-5125	16	1
6240-00-155-7836	20	1	5310-00-672-2178	2	2
6240-00-155-7836	25	45	5310-00-672-2178	22	17
5905-00-171-1999	27	10	5310-00-672-2178	25	27
5905-00-171-2006	27	12	5905-00-681-8635	23	10
5325-00-174-9332	25	24	5940-00-682-2477	20	18
5970-00-181-0516	22	39	5935-00-683-7892	23	13
5905-00-190-8887	26	9	5935-00-685-9396	25	26
5305-00-206-1270	22	3	5935-00-716-6591	17	6
5305-00-206-2080	23	8	5905-00-719-4359	19	15
5310-00-208-3786	2	4	5310-00-721-8000	25	5

STOCK NUMBER	FIGURE NO	ITEM NO	STOCK NUMBER	FIGURE NO	ITEM NO
5310-00-722-5998	24	31	5961-00-855-1551	26	5
5120-00-724-3767	1	19	5961-00-855-1551	27	18
5120-00-724-3767	21	9	5910-00-865-3297	27	9
5999-00-728-3617	2	20	5985-00-878-7943	24	13
5999-00-728-3617	25	38	5305-00-889-2991	24	14
5935-00-761-3881	5	2	5905-00-892-7280	19	14
5935-00-762-1495	7	2	5905-00-892-7284	19	12
5935-00-762-1495	13	2	5935-00-892-9322	2	13
5935-00-762-1495	25	23	5935-00-892-9322	6	2
5935-00-762-1504	17	7	5935-00-897-2074	2	19
5905-00-763-4370	19	11	5935-00-897-2074	25	43
5935-00-771-2262	5	1	5935-00-902-2338	25	16
5935-00-771-2262	6	1	5305-00-903-2194	20	20
5935-00-771-2262	7	1	5305-00-903-2196	21	6
5935-00-772-9261	13	1	5935-00-903-3513	13	3
5935-00-772-9261	25	34	5935-00-904-1373	2	18
5310-00-773-7624	22	20	5935-00-904-1373	25	41
5310-00-773-7624	25	13	5999-00-904-3486	22	14
5305-00-781-5664	18	6	5935-00-910-5098	2	11
5310-00-782-1349	20	10	5961-00-911-6185	27	1
5935-00-809-0786	24	11	5935-00-913-1818	24	25
5310-00-812-4292	18	5	5961-00-917-1636	22	34
5310-00-812-4292	20	4	5310-00-924-8526	23	24
5310-00-812-4294	17	5	5905-00-926-8563	22	33
5310-00-812-4294	21	14	5310-00-928-2690	2	16
5310-00-812-4294	26	15	5310-00-928-2690	17	4
5935-00-823-0487	3	1	5310-00-928-2690	21	13
5935-00-823-0487	4	1	5310-00-928-2690	25	40
5935-00-823-0487	12	2	5310-00-928-2690	26	14
5935-00-823-0487	14	2	5925-00-929-7273	25	12
5935-00-823-0487	24	12	5310-00-933-8118	25	8
5315-00-823-8740	20	8	5995-00-935-0358	1	11
5935-00-825-8860	25	25	5995-00-935-0361	1	16
5935-00-826-1007	20	19	5995-00-935-0362	1	3
5935-00-826-1020	25	37	5995-00-935-0363	1	10
5935-00-827-1545	25	17	5995-00-935-0364	1	12
5940-00-827-2653	22	25	5995-00-935-0366	1	6
5940-00-827-2653	24	2	5995-00-935-0370	1	7
5940-00-827-2653	25	1	5995-00-935-0371	1	13
5365-00-828-8526	24	9	5995-00-935-0374	1	8
5365-00-828-8526	25	33	5995-00-935-0375	1	17
5935-00-832-4344	23	11	5961-00-937-7375	26	17
6625-00-832-6023	1	23			
5120-00-832-6628	21	24	5310-00-939-1063	23	19
5995-00-832-6856		4	5935-00-945-7354	9	2
5995-00-832-7124	1	9	5961-00-950-6588	22	40
5935-00-835-4861	25	35	4920-00-976-5426	1	22
5961-00-837-7262	27	13	5905-00-978-7095	19	13
6610-00-839-8638	24	32	5905-00-988-2174	19	20
5340-00-840-0954	24	18	5905-00-988-6282	19	19
5961-00-842-9621	26	18	5905-00-990-5006	19	10
5935-00-843-9008	21	21	5961-00-995-2310	26	4
5305-00-844-4371	21	2	5961-00-995-2310	27	15

PART NUMBER	FSCM	FIG NO	ITEM NO	PART NUMBER	FSCM	FIG NO	ITEM NO
AN3420-10	88044	24	8	CX10573U6FT	80063	1	5
AN3420-6	88044	24	9	CX10574ARC131	80063	1	4
AN3420-6A	88044	25	33	CX10575U6FT	80063	1	7
AN3420-8	88044	24	10	CX10576U6FT	80058	1	9
AN960C4	88044	20	10				
CG3370U6FT	80063	1	11				
CG3370U8IN	80063	1	6	DDMF-50S	71468	2	18
CG3371U6FT	80063	1	10	DDMF-50S	71468	25	41
CG3372U6FT	80063	1	12	DD50925-1	71468	2	19
CG3373U6FT	80063	1	3	DE24657-5	71468	17	6
CG3374U2FT	80063	1	16	DM53740-5005	71468	2	11
CG3375U4FT	80063	1	15	DM53742-5004	71468	2	20
CG3376U6FT	80063	1	13	DM53742-5004	71468	25	68
CK16AX473M	81349	27	17	D4-128	95987	2	12
CL21CE400UP3	81349	27	9	D4-128	95987	22	17
CL23CJ1R5TN3	81349	27	2	D4-128	95987	25	27
CL25BJ180TP3	81349	27	8	D6-128	95987	21	11
CL25BN080SP3	81349	26	19	D6-128	95987	22	28
CX10569ARC131	80058	1	2				
CX10570U4FT	80063	1	8	ID48ARN	80058	24	32
CX10571U4FT	80063	1	17	JAN1N3996A	81349	22	40
CX10572U6FT	80063	1	14	JAN1N4249	81349	22	44

PART NUMBER	FSCM	FIG NO	ITEM NO	PART NUMBER	FSCM	FIG NO	ITEM NO
JAN1N645	81349	20	17	MS39087-4	96906	24	18
JAN1N645	81349	26	2	MS4308-1-1	96906	17	3
JAN1N752A	81349	26	4	MS4308-3-5	96906	2	15
JAN1N752A	81349	27	15	MS51957-1	96906	18	7
JAN2N1132	81349	26	5	MS51957-13	96906	20	16
JAN2N1132	81349	27	18	MS51957-13	96906	22	6
JAN2N697	81349	27	13	MS51957-13	96906	25	42
JAN2N914	81349	27	1	MS51957-14	96906	2	14
MR26W050DCVVR	81349	23	26	MS51957-14	96906	23	1
MS15795-802	96906	21	12	MS51957-14	96906	24	33
MS15795-803	96906	23	25	MS51957-15	96906	22	41
MS15795-805	96906	24	31	MS51957-15	96906	24	19
MS16108-1A	96906	25	26	MS51957-15	96906	25	15
MS16562-192	96906	20	8	MS51957-16	96906	22	13
MS24693C14	96906	20	20	MS51957-16	96906	24	20
MS24693C271	96906	18	6	MS51957-18	96906	23	27
MS24693C272	96906	24	16	MS51957-2	96906	25	39
MS24693C3	96906	20	21	MS51957-28	96906	22	88
MS24693C34	96906	21	6	MS51957-28	96906	25	14
MS24693C4	96906	2	8	MS51957-3	96906	2	17
MS24693C4	96906	25	30	MS51957-31	96906	22	19
MS24693C48	96906	24	14	MS51957-32	96906	24	30
MS24693C5	96906	2	7	MS51957-5	96906	17	1
MS24693C5	96906	21	3	MS51957-6	96906	26	12
MS24693C5	96906	24	35	MS77068-1	96906	20	18
MS24693C5	96906	25	29	MS77068-2	96906	22	25
MS25041-6	96906	20	2	MS77068-2	96906	24	2
MS25041-6	96906	25	44	MS77068-2	96906	25	1
MS25041-7	96906	20	25	MS91528-1N2B	96906	23	2
MS25082-8	96906	20	3	MT2330	37695	22	45
MS25082-8	96906	25	5	M26655-2-0204	81349	26	16
MS25082B11	96906	25	11	NAS1397R10B	80205	21	1
MS25082021	96906	19	3	NAS1397R10B	80205	22	29
MS25089-4GR	96906	25	9	NAS1397R2B	80205	21	10
MS25237-327	96906	20	1	NAS1397R4B	80205	22	18
MS25237-327	96906	25	45	NAS1397R6B	80205	22	27
MS25304-5	96906	25	12	NAS1397R8B	80205	2	5
MS3057-10A	96906	24	11	NAS1397R8B	80205	22	16
MS3106E18-1SC	96906	24	7	NAS1397R8B	80205	25	28
MS3110E10-6S	96906	25	16	NAS1640-10	80205	18	4
MS3112E12-10P	96906	20	19	NAS1640-2	80205	2	16
MS3112E12-10S	96906	25	37	NAS1640-2	80205	17	4
MS3112E16-26S	96906	25	17	NAS1640-2	80205	21	13
MS3112E8-4S	96906	25	25	NAS1640-2	80205	25	40
MS3116E12-10P	96906	25	35	NAS1640-2	80205	26	14
MS3116F10-6P	96906	17	7	NAS1640-4	80205	2	3
MS3116F12-10P	96906	5	1	NAS1640-4	80205	20	12
MS3116F12-10P	96906	6	1	NAS1640-4	80205	22	5
MS3116F12-10P	96906	7	1	NAS1640-4	80205	23	5
MS3116F12-10S	96906	7	2	NAS1640-4	80205	24	4
MS3116F12-10S	96906	13	2	NAS1640-4	80205	25	2
MS3116F12-10S	96906	25	23	NAS1640-6	80205	22	7
MS3116F16-26P	96906	13	1	NAS164012	80205	23	29
MS3116F16-26P	96906	25	34	NAS43DD0-64	80205	20	14
MS3116F16-26SW	96906	13	3	NAS557-10B	80205	22	23
MS3116F24-61S	96906	24	25	NAS557-10C	80205	22	30
MS3116F8-4P	96906	5	2	NAS557-4B	80205	22	38
MS3116F8-4S	96906	2	13	NAS557-6B	80205	22	15
MS3116F8-4S	96906	6	2	NAS557-6C	80205	22	26
MS35058-22	96906	23	22	NAS557-8B	80205	22	43
MS35058-23	96906	23	23	NAS620C2	80205	17	2
MS35058-31	96906	23	14	NAS620C2	80205	26	13
MS3505823	96906	23	16	NAS620C4	80205	22	12
MS35125-2	96906	21	20	NAS620C4	80205	23	3
MS35168-88E	96906	3	1	NAS620C4	80205	24	3
MS35168-88E	96906	4	1	NAS620C6	80205	22	20
MS35168-88E	96906	12	2	NAS620C6	80205	25	13
MS35168-88E	96906	14	2	NAS662C2R6	80205	21	2
MS35168-88E	96906	24	12	NAS671C10	80205	18	5
MS35173-274B	96906	23	13	NAS671C10	80205	20	4
MS35175-291C	96906	23	11	NAS671C11	80205	23	30
MS35179-1094A	96906	21	21	NAS671C2	80205	17	5
MS35214-11	96906	22	3	NAS671C2	80205	21	14
MS35233-12	96906	19	25	NAS671C2	80205	26	15
MS35333-73	96906	20	5	NAS671C4	80205	2	4
MS35338-135	96906	25	8	NAS671C4	80205	20	11
MS35431-1	96906	22	37	NAS671C4	80205	22	9
MS35431-1	96906	27	11	NAS671C4	80205	23	4
MS35489-38	96906	25	22	NAS671C4	80205	24	5
MS35489-48	96906	25	24	NAS671C4	80205	25	3

PART NUMBER	FSCM	FIG NO	ITEM NO	PART NUMBER	FSCM	FIG NO	ITEM NO
NAS671C6	80205	21	16	SMC620672	80063	2	6
NAS671C6	80205	22	22	SMC620672	80062	25	31
NO. 4, INTERNAL TOOTH	81349	23	19	SMC620674	80063	2	1
PB01FA03	81349	23	28	SMC620694	80063	20	6
PB01FA04	81349	23	32	SMC620696	80063	20	15
PR31/2-6.375	72793	24	24	SMC620697	80063	24	17
RA-50	23042	24	13	SMC620699	80063	2	12
RC20GF101J	81349	26	3	SMC620702	80063	24	22
RC20GF101J	81349	27	3	SMC620734	80063	18	1
RC20GF152J	81349	26	6	SMC620746-1	80063	21	22
RC20GF183J	81349	27	7	SMC620746-2	80063	21	15
RC20GF201J	81349	27	16	SMC620747	80063	1	20
RC20GF202J	81349	26	9	SMC620749	80063	21	19
RC20GF271J	81349	27	12	SMD620250	80063	24	29
RC20GF302J	81349	26	20	SMD620640	80063	24	23
RC20GF4R3J	81349	27	14	SMD620642	80063	22	21
RC20GF621J	81349	23	21	SMD620649	80063	22	10
RC20GF622J	81349	27	6	SMD620733	80063	24	34
RC20GF623J	81349	27	5	SM4999ARC131	80063	1	23
RC20GF751J	81349	26	7	SR-6P	28520	25	18
RC20GF821J	81349	27	10	TL711AARM79	80058	1	21
RC20GF912J	81349	27	4	TL758ARC131	80063	1	18
RE70N30R9	81349	22	33	TL758ARC131	80058	21	24
RN65D11R5F	81349	19	18	TS2575ARC131	80058	1	1
RN65D1500F	81349	19	13	TXB2P-032-037	98978	22	14
RN65D17R8F	81349	19	19	UG414AU	81349	23	12
RN65D2490F	81349	19	27	UG625BU	81349	19	1
RN65D2940F	81349	19	12	U92AU	81349	16	1
RN65D37R4F	81349	19	20	U93AU	81349	16	2
RN65D4320F	81349	19	11	03-1008-01	04423	19	6
RN65D5R76F	81349	19	15	03-1021-01	04423	19	5
RN65D61R9F	81349	19	28	035692LKW	55597	23	20
RN65D71R1F	81349	19	21	035692LKW	55597	25	4
RN65D8660F	81349	19	10	035692LKW	65597	20	24
RN65D96R2F	81349	19	14	09-4329-01	04423	19	23
RT10C2L102	81349	26	11	1-4-28UNF	81349	23	24
RV4NAYSXD253B	81349	23	10				
RW69VR10	81349	25	6				
RW69VR47	81349	26	1	1N4143	81349	26	17
RW69V510	81349	26	10				
SMB619786	80063	22	39	11-0077-01	04423	19	4
SMB619787	80063	22	36	119392	78947	23	6
SMB619997-1	80063	23	9	13-0208-01	04423	19	2
SMB620240	80063	22	31	13-0260-01	04423	19	24
SMB620655	80063	22	32	13210	79061	14	1
SMB620665	80063	24	26	13210	79061	15	2
SMB620668-1	80063	25	19	15-0029-01	04423	19	16
SMB620668-2	80063	25	21	15-0031-01	04423	19	7
SMB620674	80063	25	36	15-0032-01	04423	19	29
SMB620685	80063	10	1	15-0033-01	04423	19	22
SMB620685	80063	12	1	15-0034-01	04423	19	26
SMB620690	80063	20	23	15-0040-01	04423	19	17
SMB620693	80063	20	7				
SMB620703	80063	24	21	2F15	96873	18	3
SMB6207050	80063	21	18	2N3441	81349	22	42
SMB620711	80063	24	15	2N3790	81349	22	34
SMB620735	80063	2	10	2106103	13209	22	36
SMB620735	80063	25	32	22-0009-08	04423	19	8
SMB620741	80063	21	7	24A	76545	25	20
SMB620742	80063	21	8	274-MB	24655	15	1
SMB620743	80063	21	5	274MB	24655	11	1
SMB620744	80063	21	4	30	76545	10	3
SMB620745	80063	21	17	302	83330	10	2
SMB620752	80063	2	9	304-004	98978	22	4
SMC619510-2	80063	21	23	37-0002-01	04423	19	9
SMC619644-9	80063	22	11	37TB12TBLD37	81349	22	24
SMC619657-2	80063	26	8	4-4ONC	81349	23	18
SMC619789	80063	26	18				
SMC620238	80063	20	22	51-024-0000	98291	9	2
SMC620248	80063	20	13	51-025-0000	98291	8	2
SMC620627	80063	1	19	5284	73899	21	9
SMC620628	80063	1	22	68800	74284	18	2
SMC620629	80063	1	24	819B1800W	94375	8	1
SMC620661	80063	23	17	819B1800W	94375	9	1
SMC620662	80063	24	6	819B1800W	91375	22	2
SMC620663	80063	24	1	8311-20	70998	22	1
SMC620671	80063	25	43	875-032X5V02037	01939	20	9

LATEST NATIONAL STOCK NUMBER ASSIGNMENTS

STOCK NUMBER	FIGURE NO	ITEM NO	STOCK NUMBER	FIGURE NO	ITEM NO
5910-00-051-4996	26	19	5365-00-618-9335	20	14
5961-00-054-4141	22	42	5325-00-660-0973	22	23
5305-00-054-5646	19	25	5340-00-766-6818	21	10
5905-00-104-8337	26	7	5325-00-826-1062	22	26
5905-00-106-9344	26	3	5310-00-854-9382	25	11
5905-00-106-9344	27	3	5910-00-926-8217	26	16
5910-00-134-9615	27	2	5310-00-929-6395	22	7
5910-00-158-5367	27	17	6625-00-935-0332	1	15
5940-00-204-8350	25	20	5995-00-935-0365	1	14
5995-00-241-6239	1	2	5995-00-935-0367	1	5
5325-00-543-4448	22	43			

LATEST PART NUMBER ASSIGNMENTS

PART NUMBER	FSCM	FIG NO	ITEM NO	PART NUMBER	FSCM	FIG NO	ITEM NO
MS17830-4C	96906	23	7	100022-0200	65597	23	15
MS17830-4C	96906	25	7	118341	45413	23	8
MS35338-69	96906	25	10	9062928	18876	23	31
SMD620682	80063	1	25				

RECOMMENDED CHANGES TO EQUIPMENT TECHNICAL MANUALS



THEN... JOT DOWN THE DOPE ABOUT IT ON THIS FORM, TEAR IT OUT, FOLD IT AND DROP IT IN THE MAIL!

SOMETHING WRONG WITH THIS MANUAL?

FROM: (YOUR UNIT'S COMPLETE ADDRESS)
 Commander
 Stateside Army Depot
 ATTN: AMSTA-US
 Stateside, N.J. 07703

DATE 10 July 1975

PUBLICATION NUMBER: TM 11-5840-340-12
 DATE: 23 Jan 74
 TITLE: Radar Set AN/APC-76

BE EXACT... PIN-POINT WHERE IT IS IN THIS SPACE TELL WHAT IS WRONG AND WHAT SHOULD BE DONE ABOUT IT:

PAGE NO.	PARA-GRAPH	FIGURE NO.	TABLE NO.	
2-25	2-28			<p>Recommend that the installation antenna alignment procedure be changed through to specify a 2° IFF antenna lag rather than 1°.</p> <p>REASON: Experience has shown that with only a 1° lag, the antenna servo system is too sensitive to wind gusting in excess of 25 knots, and has a tendency to rapidly accelerate and decelerate as it hunts, causing strain to the drive train. Hunting is minimized by adjusting the lag to 2° without degradation of operation.</p>
3-10	3-3		3-1	<p>Item 5, Function column. Change "2 db" to "3db."</p> <p>REASON: The adjustment procedure for the TRANS POWER FAULT indicator calls for a 3 db (500 watts) adjustment to light the TRANS POWER FAULT indicator.</p>
5-6	5-8			<p>Add new step f.1 to read, "Replace cover plate removed in step e.1, above."</p> <p>REASON: To replace the cover plate.</p>
		FO3		<p>Zone C 3. On J1-2, change "+24 VDC to "+5 VDC."</p> <p>REASON: This is the output line of the 5 VDC power supply. + 24 VDC is the input voltage.</p>

TEAR ALONG DOTTED LINE

TYPED NAME, GRADE OR TITLE, AND TELEPHONE NUMBER
 SSG I. M. DeSpirito 999-1776

SIGN HERE:

RECOMMENDED CHANGES TO EQUIPMENT TECHNICAL MANUALS



THEN... JOT DOWN THE DOPE ABOUT IT ON THIS FORM, TEAR IT OUT, FOLD IT AND DROP IT IN THE MAIL!

SOMETHING WRONG WITH THIS MANUAL?

FROM: (YOUR UNIT'S COMPLETE ADDRESS)

DATE

PUBLICATION NUMBER

DATE

TITLE

BE EXACT... PIN-POINT WHERE IT IS

IN THIS SPACE TELL WHAT IS WRONG AND WHAT SHOULD BE DONE ABOUT IT:

PAGE NO.	PARA-GRAPH	FIGURE NO.	TABLE NO.
----------	------------	------------	-----------

TEAR ALONG DOTTED LINE

TYPED NAME, GRADE OR TITLE, AND TELEPHONE NUMBER

SIGN HERE:

DA FORM 2028-2 (TEST)
1 AUG 74

P.S.--IF YOUR OUTFIT WANTS TO KNOW ABOUT YOUR MANUAL "FIND," MAKE A CARBON COPY OF THIS AND GIVE IT TO YOUR HEADQUARTERS.

FILL IN YOUR
UNIT'S ADDRESS

FOLD BACK

DEPARTMENT OF THE ARMY

OFFICIAL BUSINESS

Commander
US Army Electronics Command
ATTN: DRSEL-MA-Q
Fort Monmouth, New Jersey 07703

FOLD BACK

TEAR ALONG DOTTED LINE

RECOMMENDED CHANGES TO EQUIPMENT TECHNICAL MANUALS



SOMETHING WRONG WITH THIS MANUAL?

THEN . . . JOT DOWN THE DOPE ABOUT IT ON THIS FORM, TEAR IT OUT, FOLD IT AND DROP IT IN THE MAIL!

FROM: (YOUR UNIT'S COMPLETE ADDRESS)

DATE

PUBLICATION NUMBER

DATE

TITLE

BE EXACT. . . PIN-POINT WHERE IT IS

IN THIS SPACE TELL WHAT IS WRONG AND WHAT SHOULD BE DONE ABOUT IT:

PAGE NO.	PARA-GRAPH	FIGURE NO.	TABLE NO.
----------	------------	------------	-----------

TEAR ALONG DOTTED LINE

TYPED NAME, GRADE OR TITLE, AND TELEPHONE NUMBER

SIGN HERE:

DA FORM 2028-2 (TEST)
1 AUG 74

P.S.--IF YOUR OUTFIT WANTS TO KNOW ABOUT YOUR MANUAL "FIND," MAKE A CARBON COPY OF THIS AND GIVE IT TO YOUR HEADQUARTERS.

FILL IN YOUR
UNIT'S ADDRESS

FOLD BACK

DEPARTMENT OF THE ARMY

OFFICIAL BUSINESS

Commander
US Army Electronics Command
ATTN: DRSEL-MA-Q
Fort Monmouth, New Jersey 07703

FOLD BACK

TEAR ALONG DOTTED LINE

FILL IN YOUR
UNIT'S ADDRESS

FOLD BACK

DEPARTMENT OF THE ARMY

OFFICIAL BUSINESS

Commander
US Army Electronics Command
ATTN: DRSEL-MA-Q
Fort Monmouth, New Jersey 07703

FOLD BACK

TEAR ALONG DOTTED LINE

REVERSE OF DA FORM 2026-2 (TEST)

By Order of the Secretary of the Army:

BERNARD W. ROGERS
General, United States Army
Chief of Staff

Official:

PAUL T. SMITH
Major General, United States Army
The Adjutant General

DISTRIBUTION:

To be distributed in accordance with DA Form 12-36A, organizational maintenance requirements for MK-1035/ARC-131.

